

		NO.		A-22459-1	
PUMP PERFORMANCE CURVES					
TYPE		Submersible Sewage & Wastewater Pump		MODEL 100C42.2 -E1 TOS100C42.2 -E1	
				FREQUENCY 50 Hz	
CUSTOMER'S NAME					
EQUIPMENT TITLE					
NO.					
		STANDARD SPECIFICATIONS		REQUIRED SPECIFICATIONS	
DISCHARGE BORE		100 mm		mm	
TOTAL HEAD		MAX. 13.5 m		m	
CAPACITY		MAX. 1.1 m ³ /min		m ³ /min	
MOTOR OUTPUT		2.2 kW		kW	
PHASE × VOLTAGE		3 φ × V		φ × V	
CURRENT		A		A	
POLES / REVOLUTION		4 P / S. S. 1500 min ⁻¹		P / min ⁻¹	
STARTING METHOD		DIRECT ON LINE			
INSULATION CLASS		F			
				REMARKS:	
					
%	kW	m	CAPACITY		
PUMP EFF.	MOTOR OUTPUT	TOTAL HEAD	m ³ /min		
TSURUMI MFG. CO., LTD.					

DIMENSION DRAWING				No.		No.	A-22463-1
TYPE	Submersible Sewage & Wastewater Pump			MODEL	100C42. 2 -E1/W1 100C43. 7 -E1/W1		

MODEL	A	A1	B	D	D1	W1	W2	H	Approximate Weight (※)
100C42. 2-E1/W1	596 (568)	154	328 (303)	324	166	522	225	641	66kg
100C43. 7-E1/W1	601 (574)	159	333 (308)	332	174	596	235	715	80kg

※excluding cable

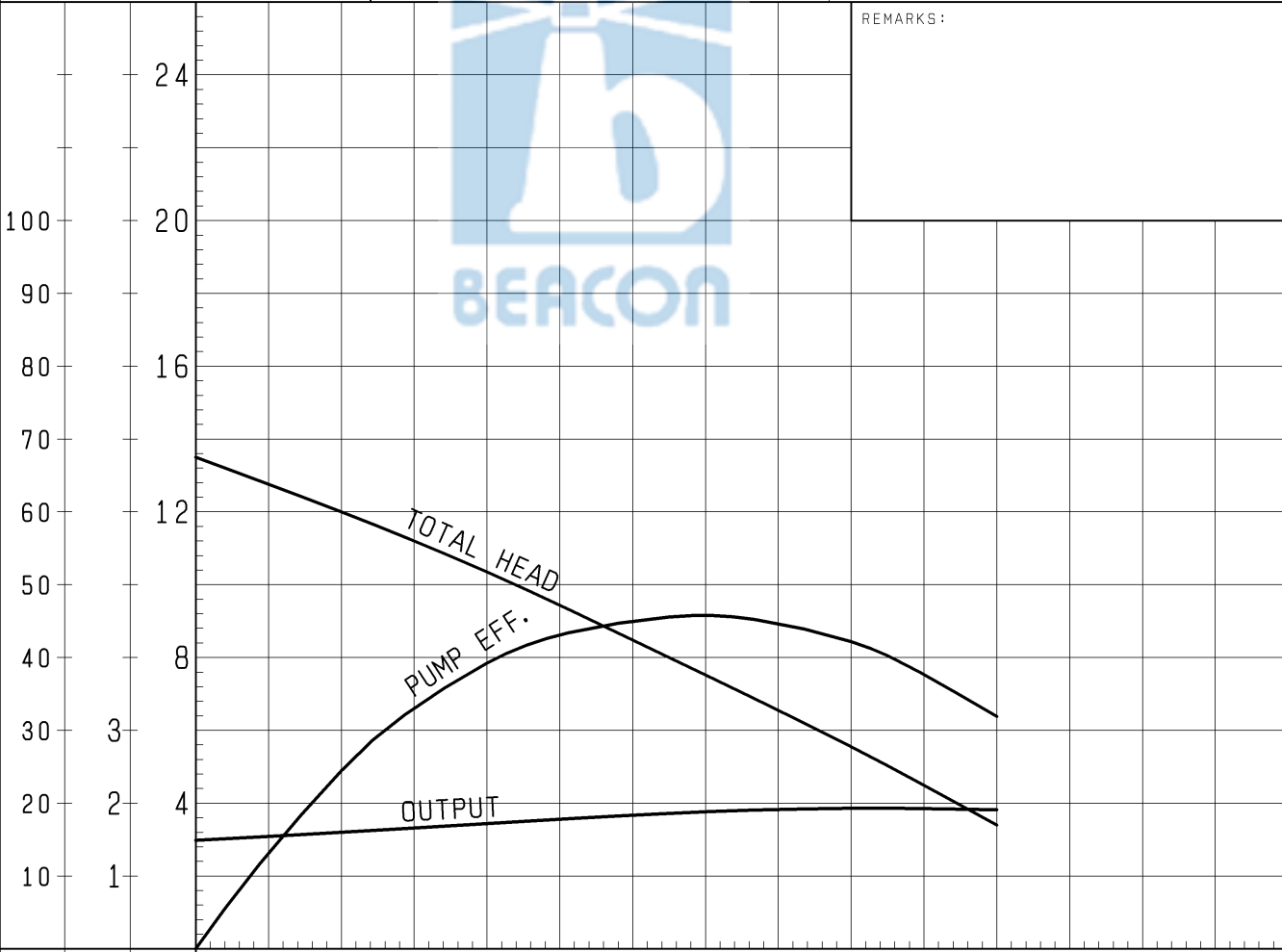
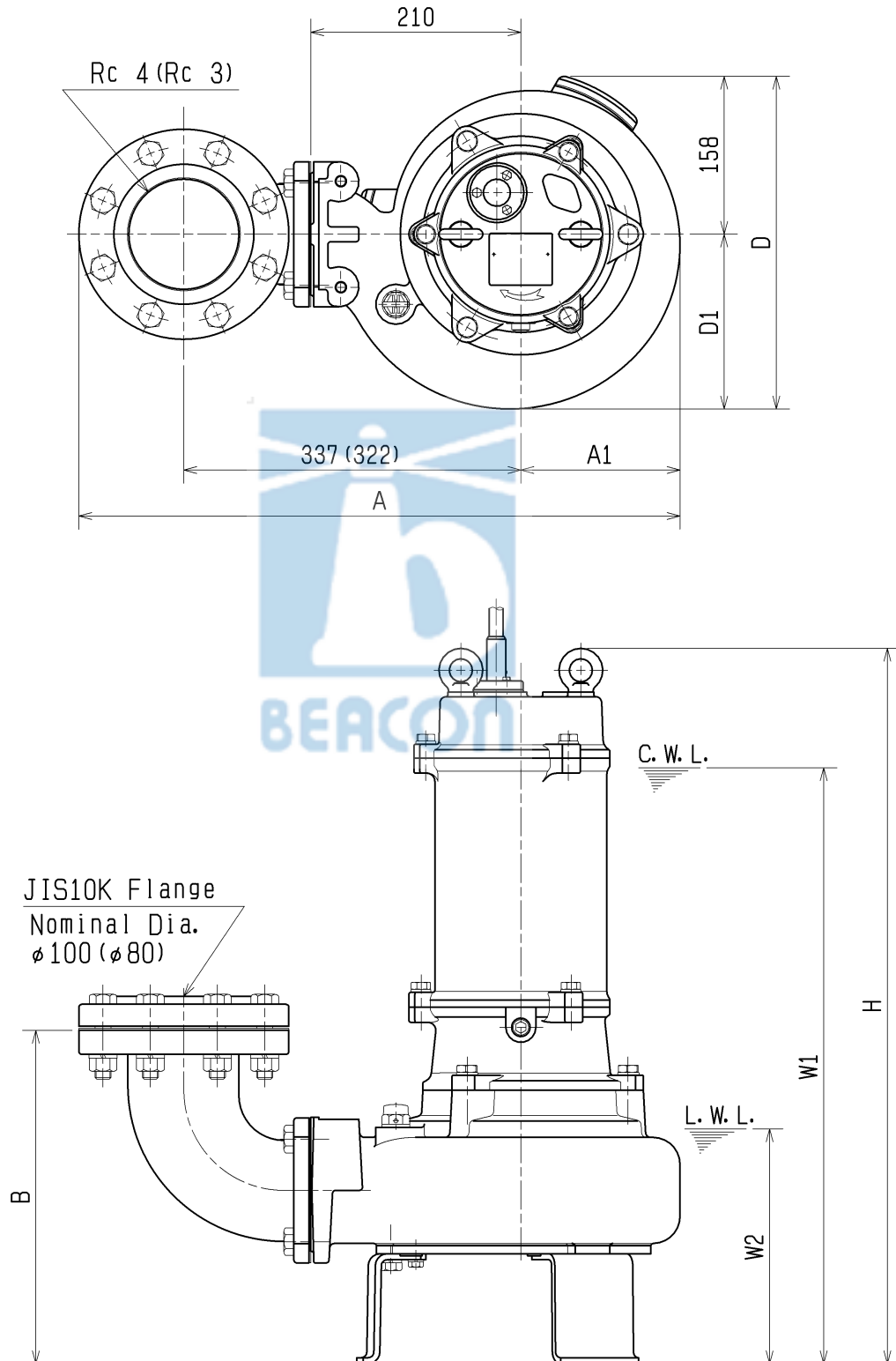

The Figure in () shows the dimensions of discharge Bore at Nominal Dia ø80.

C. W. L. :Continuous running Water Level
L. W. L. :Lowest running Water Level

SECTIONAL DRAWING			No.	No.	A-22464-2
TYPE	Submersible Sewage & Wastewater Pump		MODEL	100C42.2 -E1/W1 100C43.7 -E1/W1	

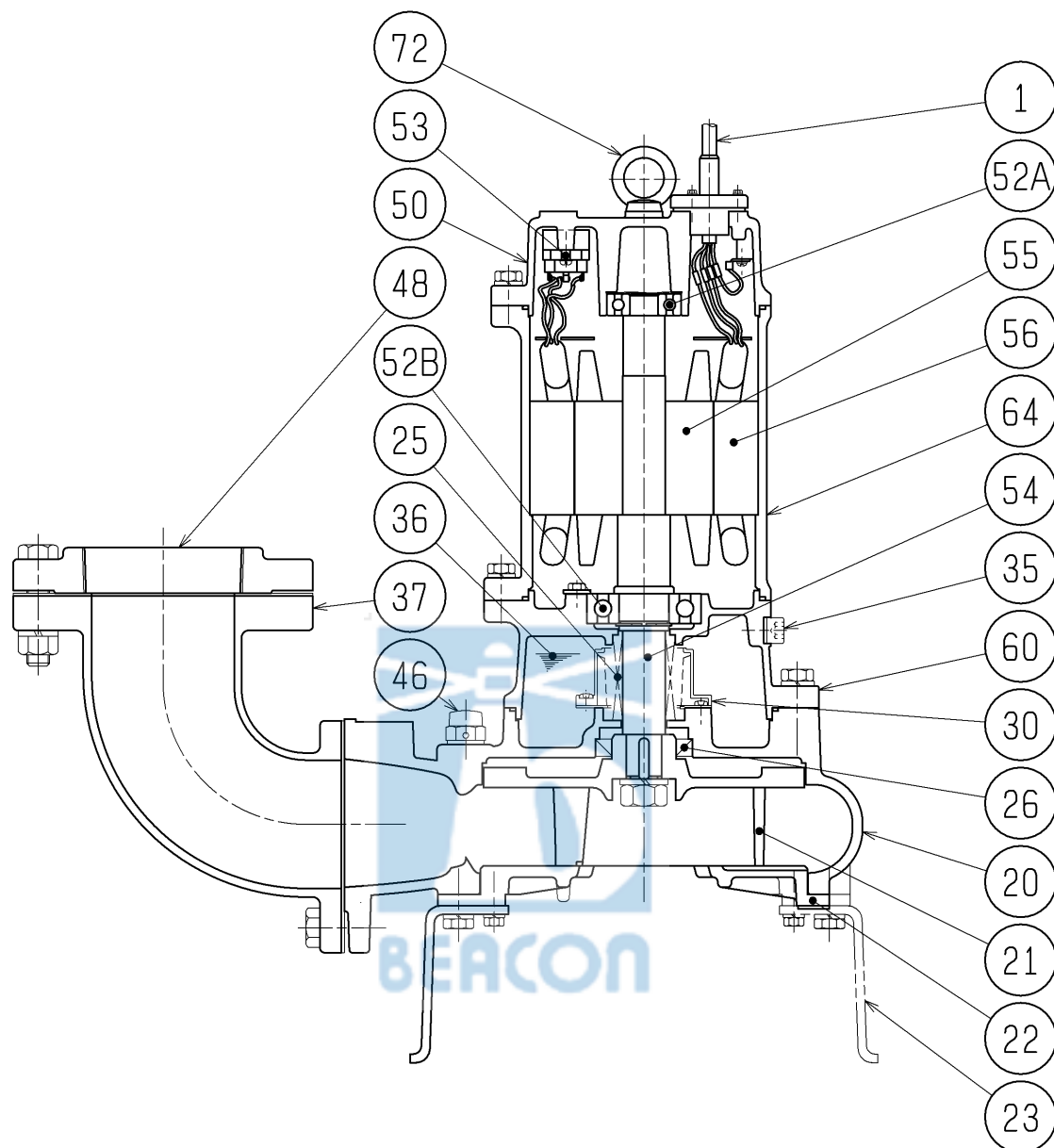

	2.2kW	3.7kW
※1	φ30	φ35
※2	456812	587212
※3	6307ZZC3	6309ZZC3

※4 the wetted part

REQ. SPECIFICATION

No.	DESCRIPTION	QTY	MATERIAL / NOTE	No.	DESCRIPTION	QTY	MATERIAL / NOTE
1	Cable	1	PVC Sheath	50	Motor Bracket	1	Gray Iron Casting
20	Pump Casing	1	Gray Iron Casting	52A	Upper Bearing	1	6304ZZC3
21	Impeller	1	Gray Iron Casting (WC Edge)	52B	Lower Bearing	1	※3
22	Suction Cover	1	Ductile Iron Casting	53	Motor Protector	1	
23	Stand	3	Steel Plate	54	Shaft	1	Stainless Steel 420J1(※4)
25	Mechanical Seal	1	※1	55	Rotor	1	
26	Oil Seal	1	※2	56	Stator	1	
30	Oil Lifter	1	Plastic	60	Bearing Housing	1	Gray Iron Casting
35	Oil Plug	1	Stainless Steel 304	64	Motor Frame	1	Gray Iron Casting
36	Lubricant		Turbine Oil (ISO VG32)	72	Eye Bolt	2	Carbon Steel Forging
37	Discharge Bend	1	Gray Iron Casting				
46	Air Release Valve	1	Nylon				
48	Screwed Flange	1	Gray Iron Casting				

NO.

A-07718-2

PUMP PERFORMANCE CURVES

TYPE Submersible Channel
Impeller Sewage Pump

MODEL 100B43.7E1-52
TOS100B43.7E1-52

FREQUENCY
50 Hz

CUSTOMER'S NAME

EQUIPMENT TITLE

NO.

	STANDARD SPECIFICATIONS	REQUIRED SPECIFICATIONS
DISCHARGE BORE	100 mm	mm
TOTAL HEAD	11 m	m
CAPACITY	1.0 m ³ /min	m ³ /min
MOTOR OUTPUT	3.7 kW	kW
PHASE × VOLTAGE	3 φ × V	φ × V
CURRENT	A	A
POLES / REVOLUTION	4 P / s. s. 1500 min ⁻¹	P / min ⁻¹
STARTING METHOD	DIRECT ON LINE	
INSULATION CLASS	E	

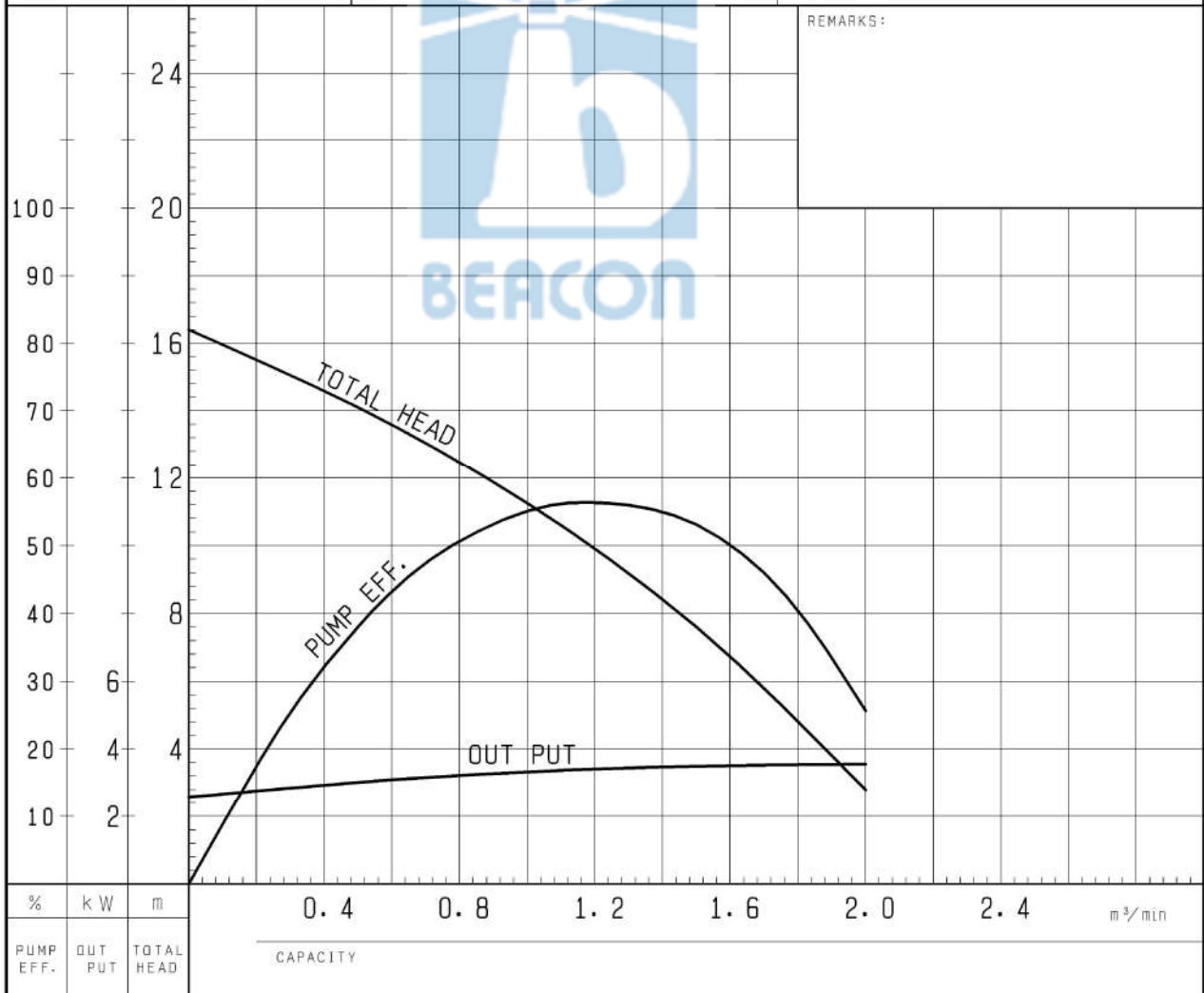

TSURUMI MFG. CO., LTD.

DIMENSION DRAWING				No.	No.	A-17067-3
TYPE	Sewage Submersible Channel Impeller Pump			MODEL	100B43.7E1-52 TOS100B43.7E1-52	

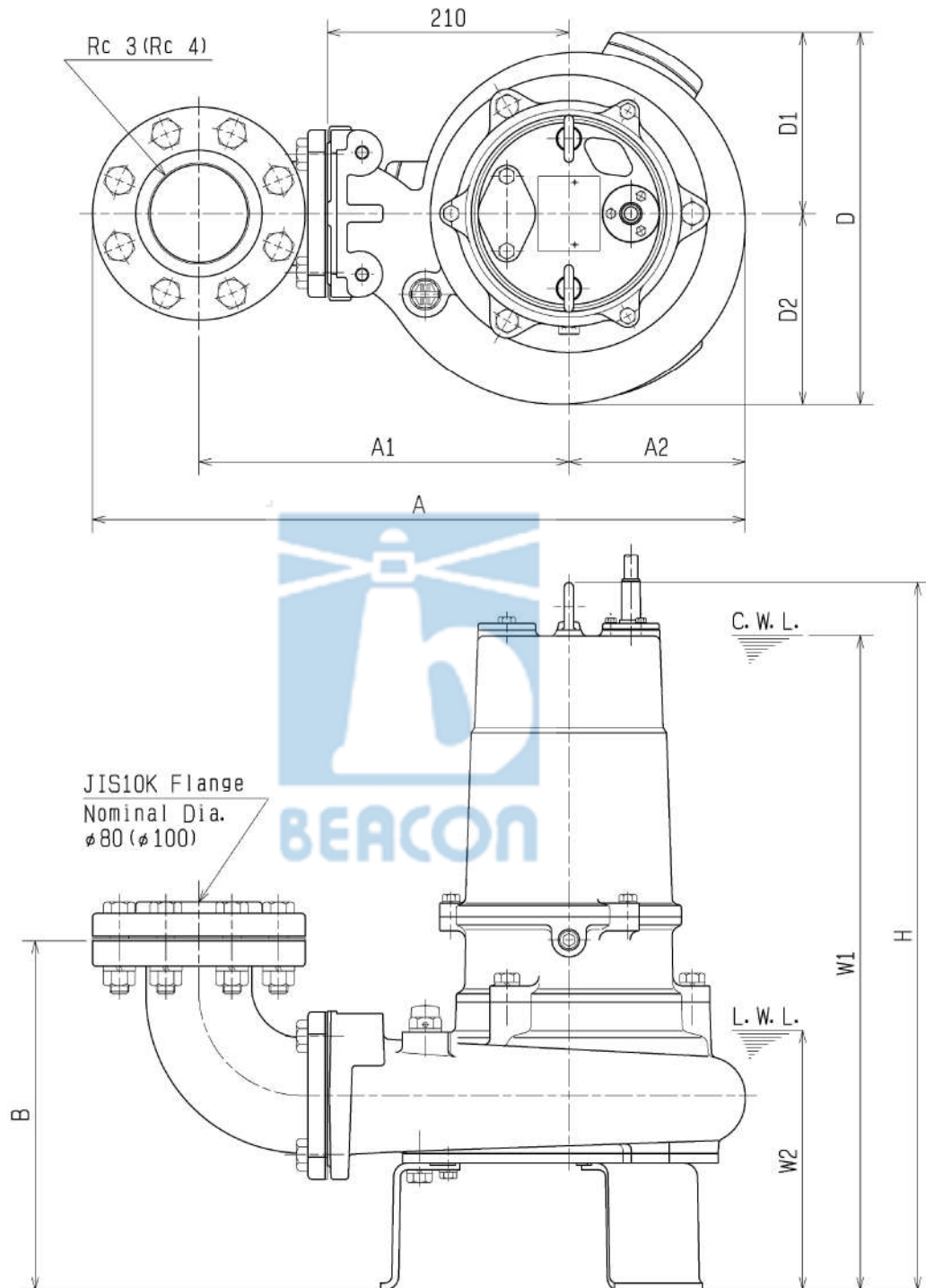

The Figure in () shows the dimensions of discharge Bore at Nominal Dia $\phi 100$.

C.W.L. : Continuous running Water Level
L.W.L. : Lowest running Water Level
※excluding cable

MODEL	A	A1	A2	B	D	D1	D2	W1	W2	H	Approximate Weight (※)
80/100B42.2-52/62	568 (596)	322 (337)	154	304 (329)	324	158	166	570	225	616	68kg
80/100B43.7-52/62	574 (601)	322 (337)	159	309 (334)	333	158	175	645	235	690	84kg

SECTIONAL DRAWING		No.	No.
TYPE Sewage Submersible Channel Impeller Pump		MODEL 100B43.7E1-52 TOS100B43.7E1-52	A-17419-2

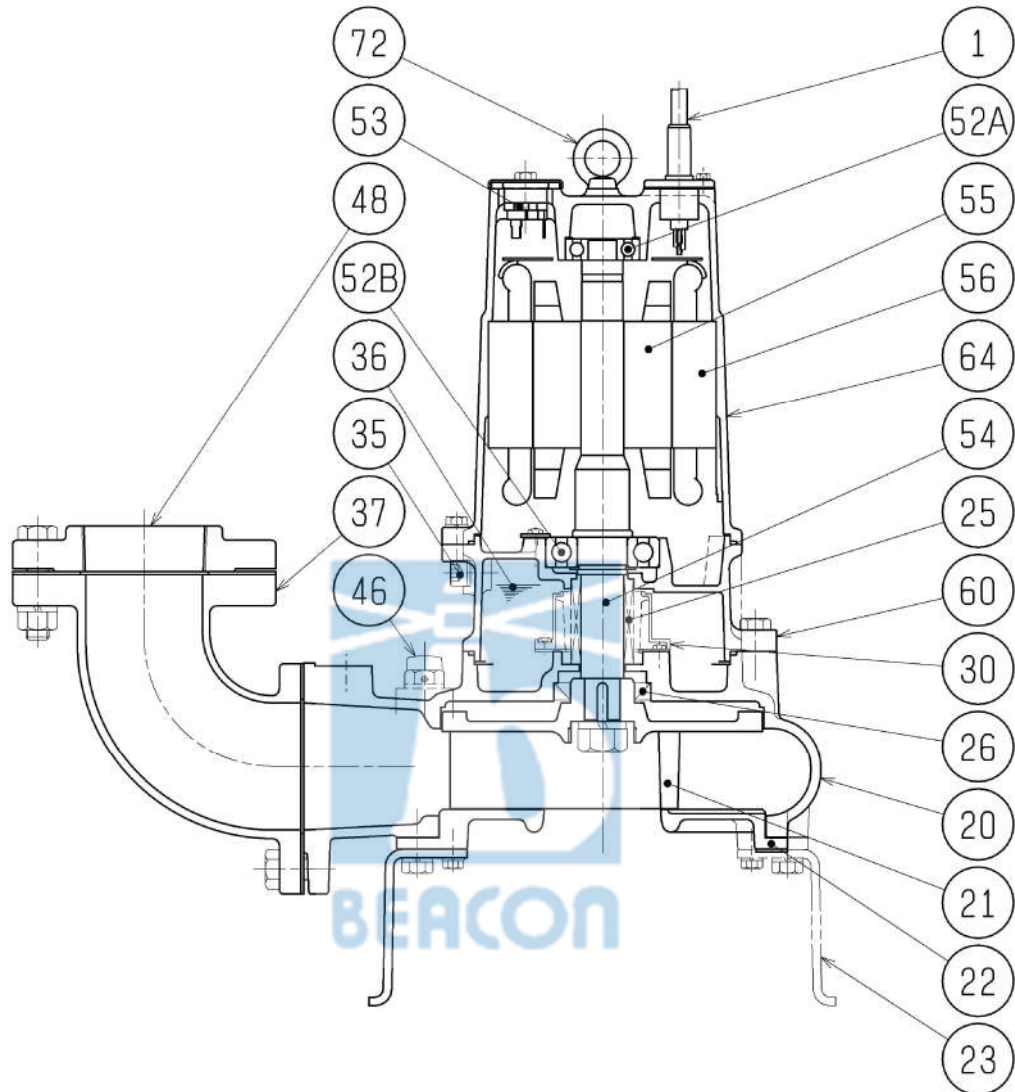

		2.2kW	3.7kW	REQ. SPECIFICATION			
※1	H-30A	H-35A					
※2	TC456812	TC507212					
※3	6307ZZC3	6309ZZC3	※4 the wetted part				
No.	DESCRIPTION	QTY	MATERIAL / NOTE	No.	DESCRIPTION	QTY	MATERIAL / NOTE
1	Cabtyre Cable	1	PVC Sheath	48	Screwed Flange	1	Gray Iron Casting
20	Pump Casing	1	Gray Iron Casting	52A	Upper Bearing	1	6304ZZC3
21	Impeller	1	Gray Iron Casting	52B	Lower Bearing	1	※3
22	Suction Cover	1	Gray Iron Casting	53	Motor Protector	1	
23	Stand	3	Steel Plate	54	Shaft	1	Stainless Steel 420J2(※4)
25	Mechanical Seal	1	※1	55	Rotor	1	
26	Oil Seal	1	※2	56	Stator	1	
30	Oil Lifter	1	Plastic	60	Bearing Housing	1	Gray Iron Casting
35	Oil Plug	1	Stainless Steel 304	64	Motor Frame	1	Gray Iron Casting
36	Lubricant		Turbine Oil (ISO VG32)	72	Eye Bolt	2	Stainless Steel 304
37	Discharge Bend	1	Gray Iron Casting				
46	Air Release Valve	1	Nylon				

NO. A-18727-1

PUMP PERFORMANCE CURVES

TYPE Sewage Submersible
Channel Impeller PumpMODEL 100B45.5 E1 - 54
TOS100B45.5 E1 - 54FREQUENCY
50 Hz

CUSTOMER'S NAME

EQUIPMENT TITLE

NO.

	STANDARD SPECIFICATIONS	REQUIRED SPECIFICATIONS
DISCHARGE BORE	100 mm	mm
TOTAL HEAD	20 m	m
CAPACITY	0.6 m ³ /min	m ³ /min
MOTOR OUTPUT	5.5 kW	kW
PHASE × VOLTAGE	3 φ × V	φ × V
CURRENT	A	A
POLES / REVOLUTION	4 P / s. s. 1500 min ⁻¹	P / min ⁻¹
STARTING METHOD	DIRECT ON LINE	
INSULATION CLASS	F	

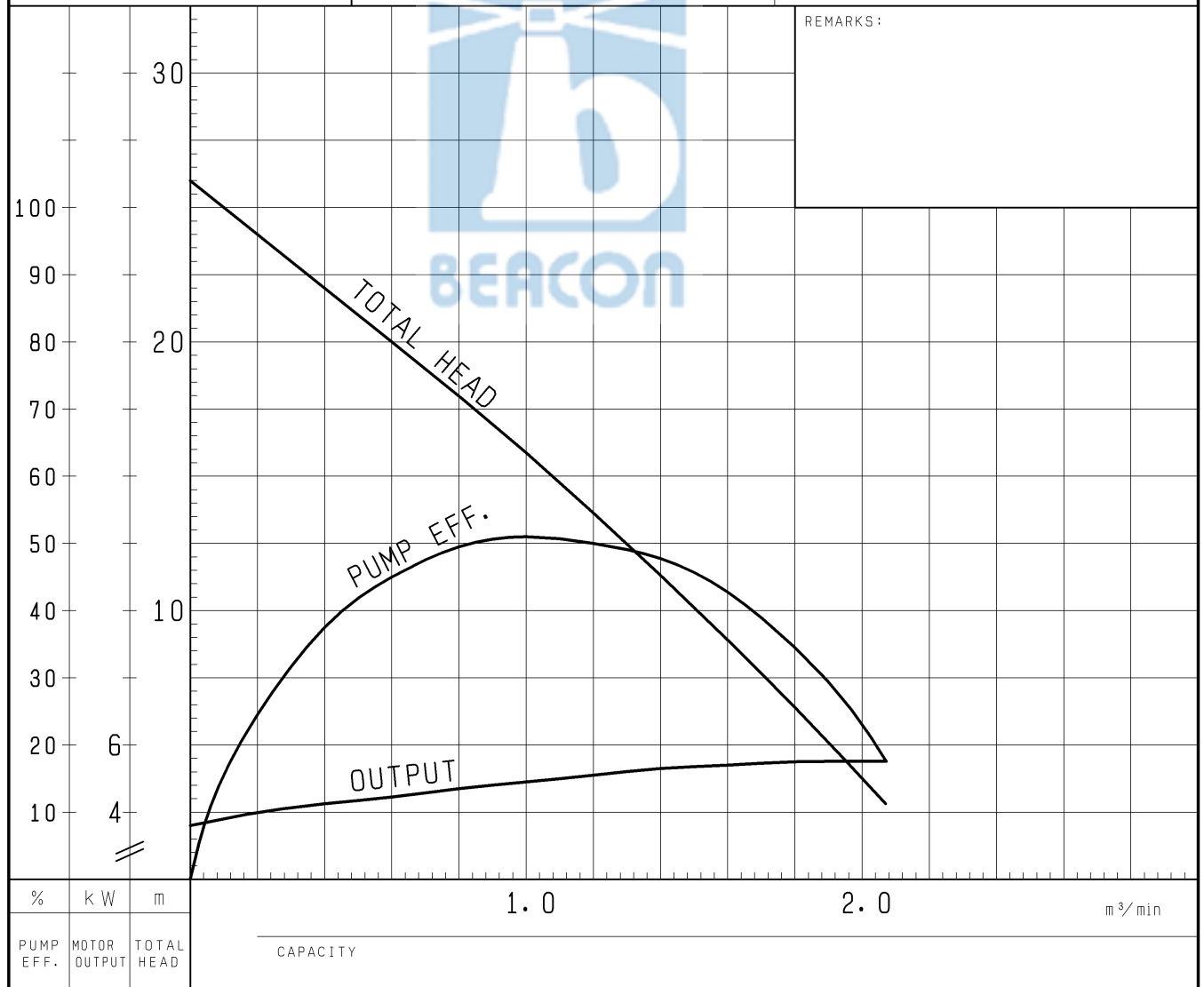

TSURUMI MFG. CO., LTD.

DIMENSION DRAWING			No.		No.	A-18775-1
TYPE	Submersible Channel Impeller Sewage Pump		MODEL	100B45.5 -54/64 100B47.5 -54/64		

MODEL	W1	H	Approximate Weight (※)
100B45.5-54/64	775	908	147kg
100B47.5-54/64	800	929	169kg

※excluding cable

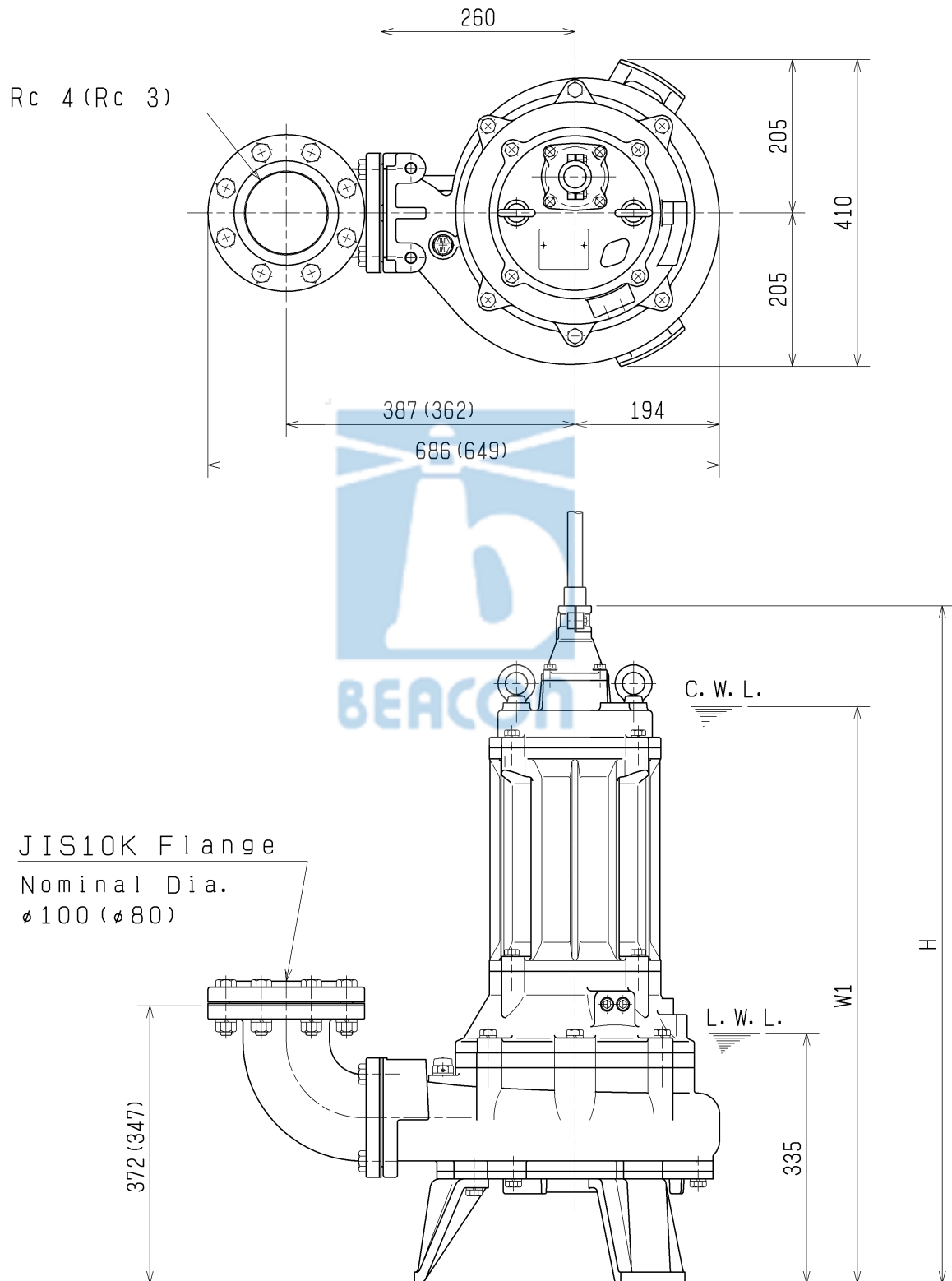

The Figure in () shows the dimensions of discharge Bore at Nominal $\phi 80$.

C.W.L. : Continuous running Water Level
L.W.L. : Lowest running Water Level

SECTIONAL DRAWING		No.	No.
TYPE Sewage Submersible Channel Impeller Pump		MODEL 100B45.5 -54/64 100B47.5 -54/64	A-18792-1

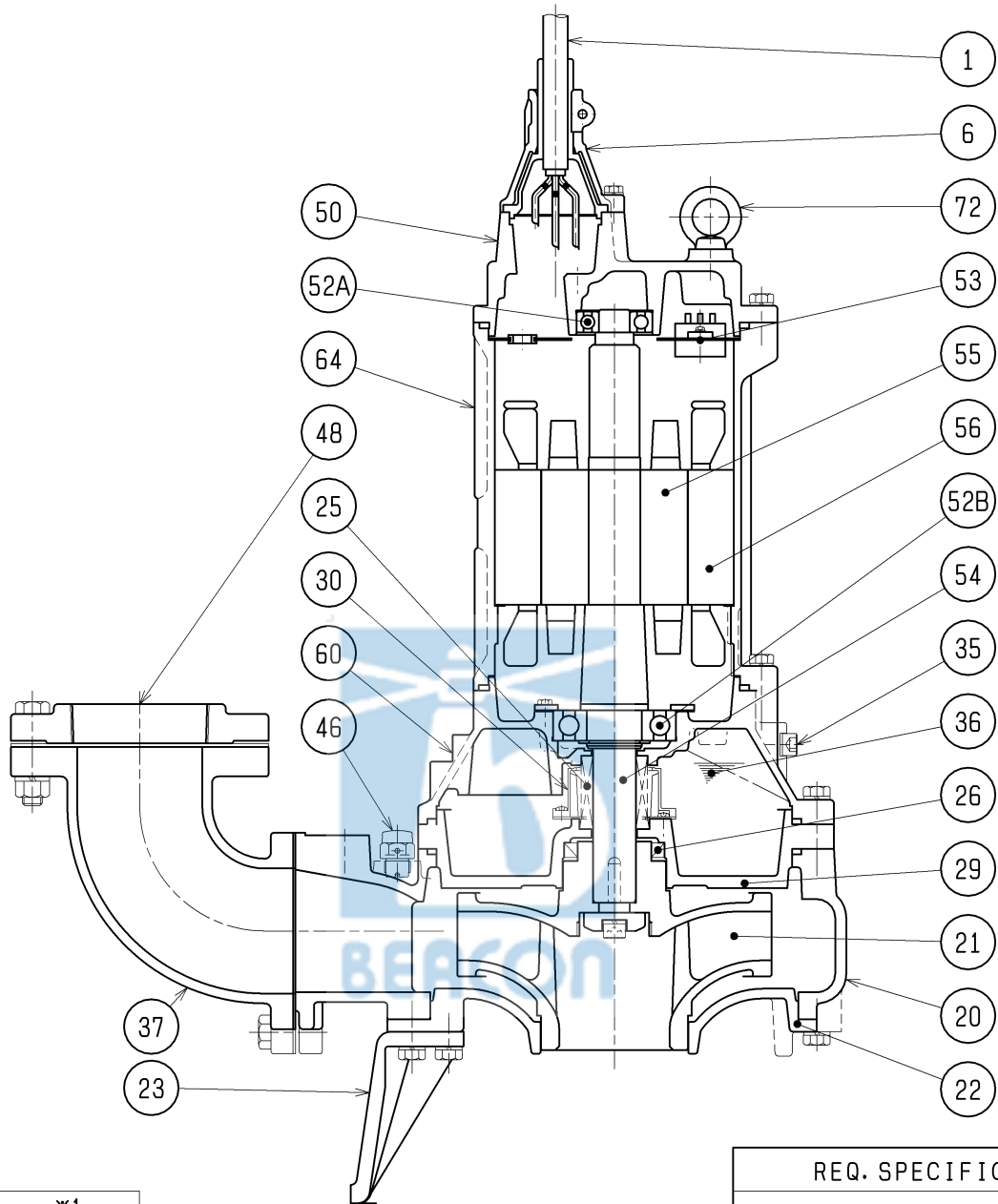

	※1
5.5kW	6305ZZC3
7.5kW	6306ZZC3

REQ. SPECIFICATION

No.	DESCRIPTION	Q'TY	MATERIAL / NOTE	No.	DESCRIPTION	Q'TY	MATERIAL / NOTE
1	Cable	1	Chloroprene Sheath	48	Screwed Flange	1	Gray Iron Casting
6	Stuffing Box	1	Gray Iron Casting	50	Motor Bracket	1	Gray Iron Casting
20	Pump Casing	1	Gray Iron Casting	52A	Upper Bearing	1	※1
21	Impeller	1	Gray Iron Casting	52B	Lower Bearing	1	6309ZZC3
22	Suction Cover	1	Gray Iron Casting	53	Motor Protector	1	
23	Stand	3	Gray Iron Casting	54	Shaft	1	Stainless Steel 420J2
25	Mechanical Seal	1	H-35A	55	Rotor	1	
26	Oil Seal	1	TC608212	56	Stator	1	
29	Oil Casing	1	Gray Iron Casting	60	Bearing Housing	1	Gray Iron Casting
30	Oil Lifter	1	Plastic	64	Motor Frame	1	Gray Iron Casting
35	Oil Plug	2	Stainless Steel 304	72	Eye Bolt	2	Structure Steel
36	Lubricant		Turbine Oil (ISO VG32)				
37	Discharge Bend	1	Gray Iron Casting				
46	Air Release Valve	1	Nylon				

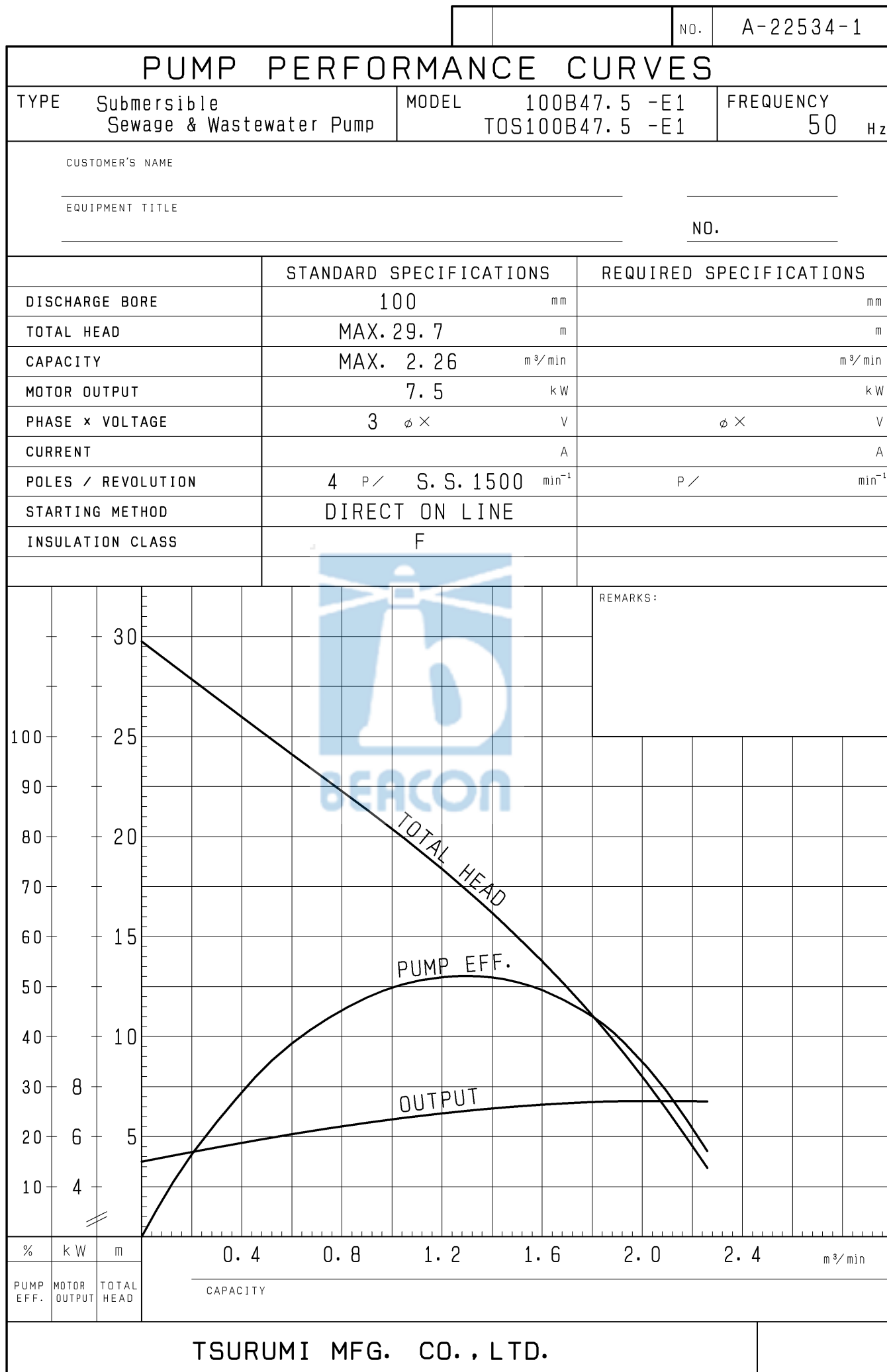

DIMENSION DRAWING			No.		No.	A-22540-2
TYPE	Submersible Sewage & Wastewater Pump		MODEL	100B45.5 -E1 100B47.5 -E1		

MODEL	W1	H	Approximate Weight (kg)
100B45.5 -E1	785	908	140kg
100B47.5 -E1	805	929	154kg

※excluding cable

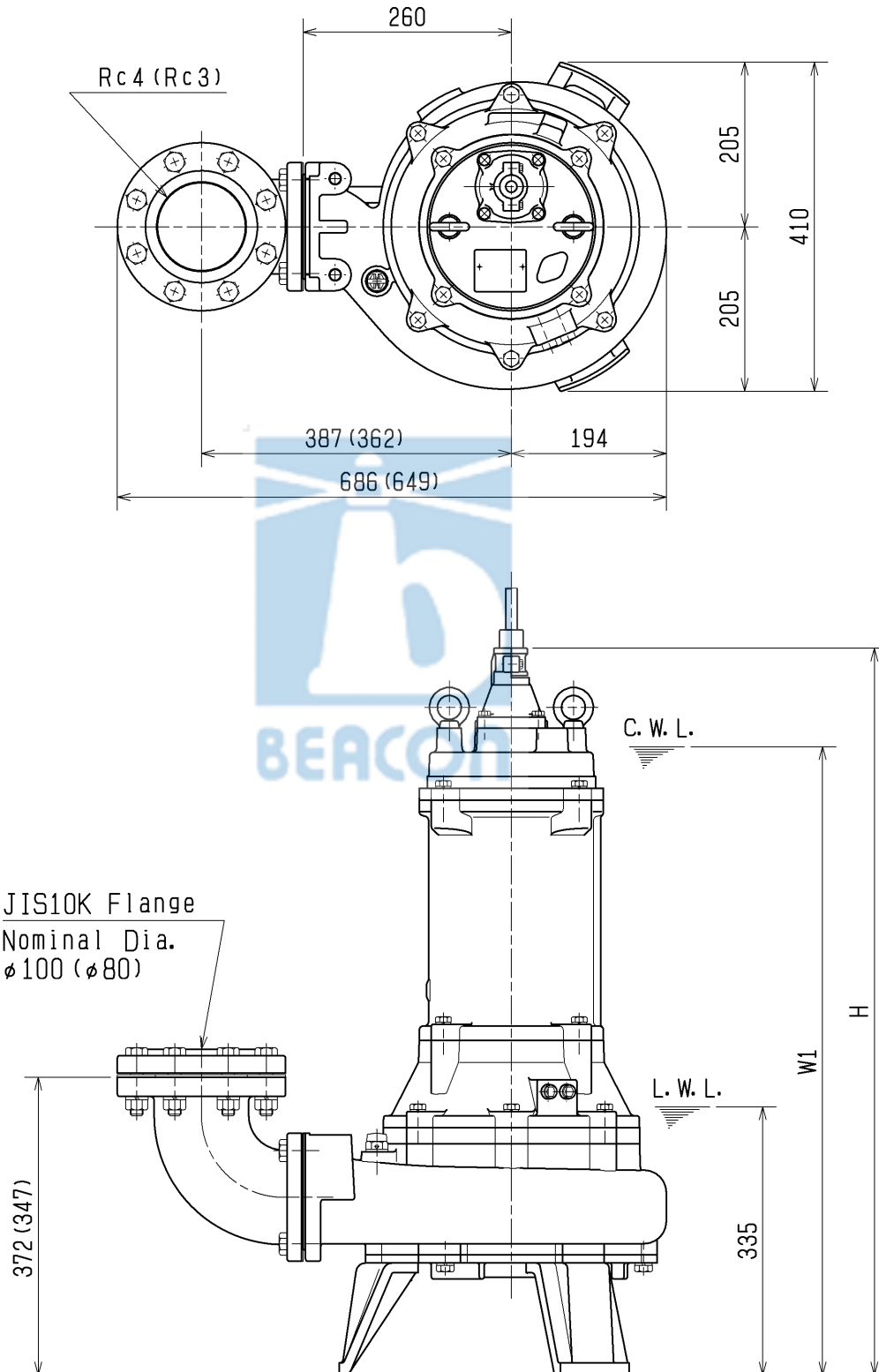

The figure in () shows the dimensions of discharge Bore at Nominal Dia $\phi 80$.

C.W.L.:Continuous running Water Level
L.W.L.:Lowest running Water Level

SECTIONAL DRAWING		No.		No.	A-22542-1
TYPE	Submersible Sewage & Wastewater Pump	MODEL	100B45.5 -E1 100B47.5 -E1		

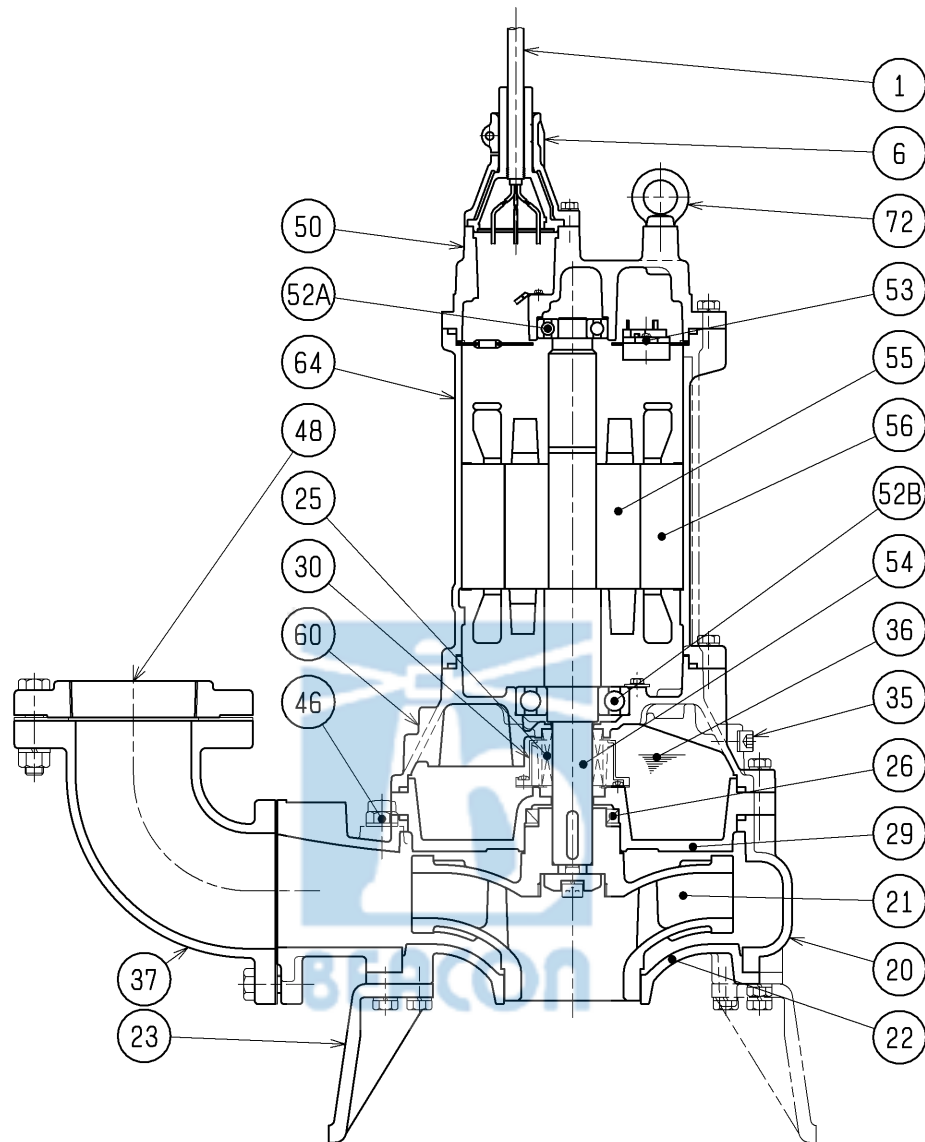

REQ. SPECIFICATION

	※1
5.5kW	6305ZZC3
7.5kW	6306ZZC3

No.	DESCRIPTION	Q'TY	MATERIAL / NOTE	No.	DESCRIPTION	Q'TY	MATERIAL / NOTE
1	Cable	1	Chloroprene Sheath	48	Screwed Flange	1	Gray Iron Casting
6	Stuffing Box	1	Gray Iron Casting	50	Motor Bracket	1	Gray Iron Casting
20	Pump Casing	1	Gray Iron Casting	52A	Upper Bearing	1	※1
21	Impeller	1	Gray Iron Casting	52B	Lower Bearing	1	6309ZZC3
22	Suction Cover	1	Gray Iron Casting	53	Motor Protector	1	
23	Stand	3	Gray Iron Casting	54	Shaft	1	Stainless Steel 420J2
25	Mechanical Seal	1	φ35	55	Rotor	1	
26	Oil Seal	1	608212	56	Stator	1	
29	Oil Casing	1	Gray Iron Casting	60	Bearing Housing	1	Gray Iron Casting
30	Oil Lifter	1	Plastic	64	Motor Frame	1	Gray Iron Casting
35	Oil Plug	2	Stainless Steel 304	72	Eye Bolt	2	Carbon Steel
36	Lubricant		Turbine Oil (ISO VG32)				
37	Discharge Bend	1	Gray Iron Casting				
46	Air Release Valve	1	Nylon				