

NO. A-20019-1

# PUMP PERFORMANCE CURVES

TYPE Submersible Cutter Sewage Pump	MODEL 50C (A/W) 2.75 -53 TOS50C (A/W) 2.75 -53	FREQUENCY 50 Hz
---	--	--------------------

CUSTOMER'S NAME \_\_\_\_\_

EQUIPMENT TITLE \_\_\_\_\_ NO. \_\_\_\_\_

	STANDARD SPECIFICATIONS	REQUIRED SPECIFICATIONS
DISCHARGE BORE	50 mm	mm
TOTAL HEAD	3 m	m
CAPACITY	0.3 m <sup>3</sup> /min	m <sup>3</sup> /min
MOTOR OUTPUT	0.75 kW	kW
PHASE x VOLTAGE	3 φ x V	φ x V
CURRENT	A	A
POLES / REVOLUTION	2 P / s. s. 3600 min <sup>-1</sup>	P / min <sup>-1</sup>
STARTING METHOD	DIRECT ON LINE	
INSULATION CLASS	E	

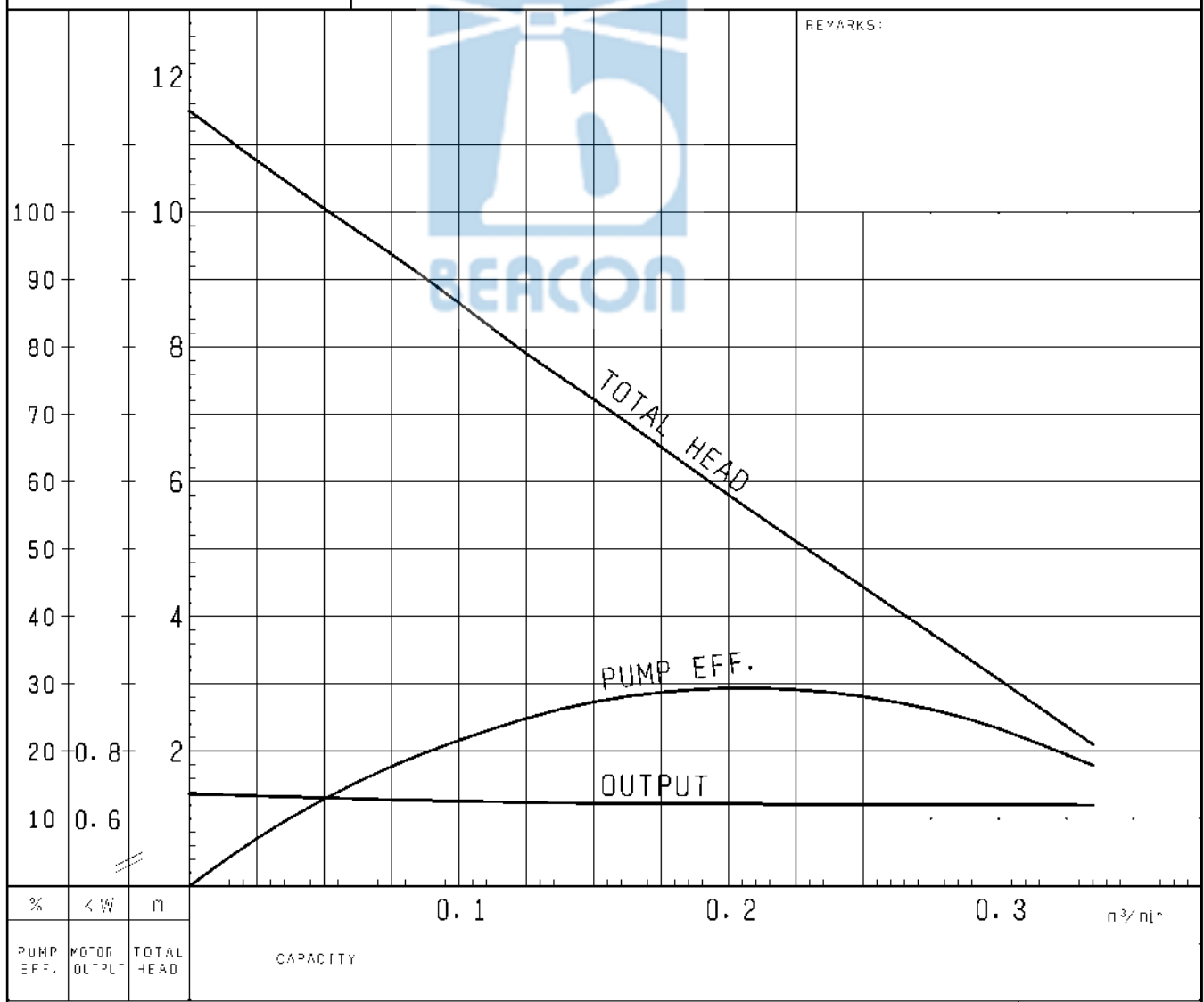

TSURUMI MFG. CO., LTD.

<b>DIMENSION DRAWING</b>		No.	No. A-20041-1
TYPE	Submersible Cutter Sewage Pump	MODEL	50C2.75 -53/63

Approximate  
Weight (kg)  
24kg  
\*excluding cable

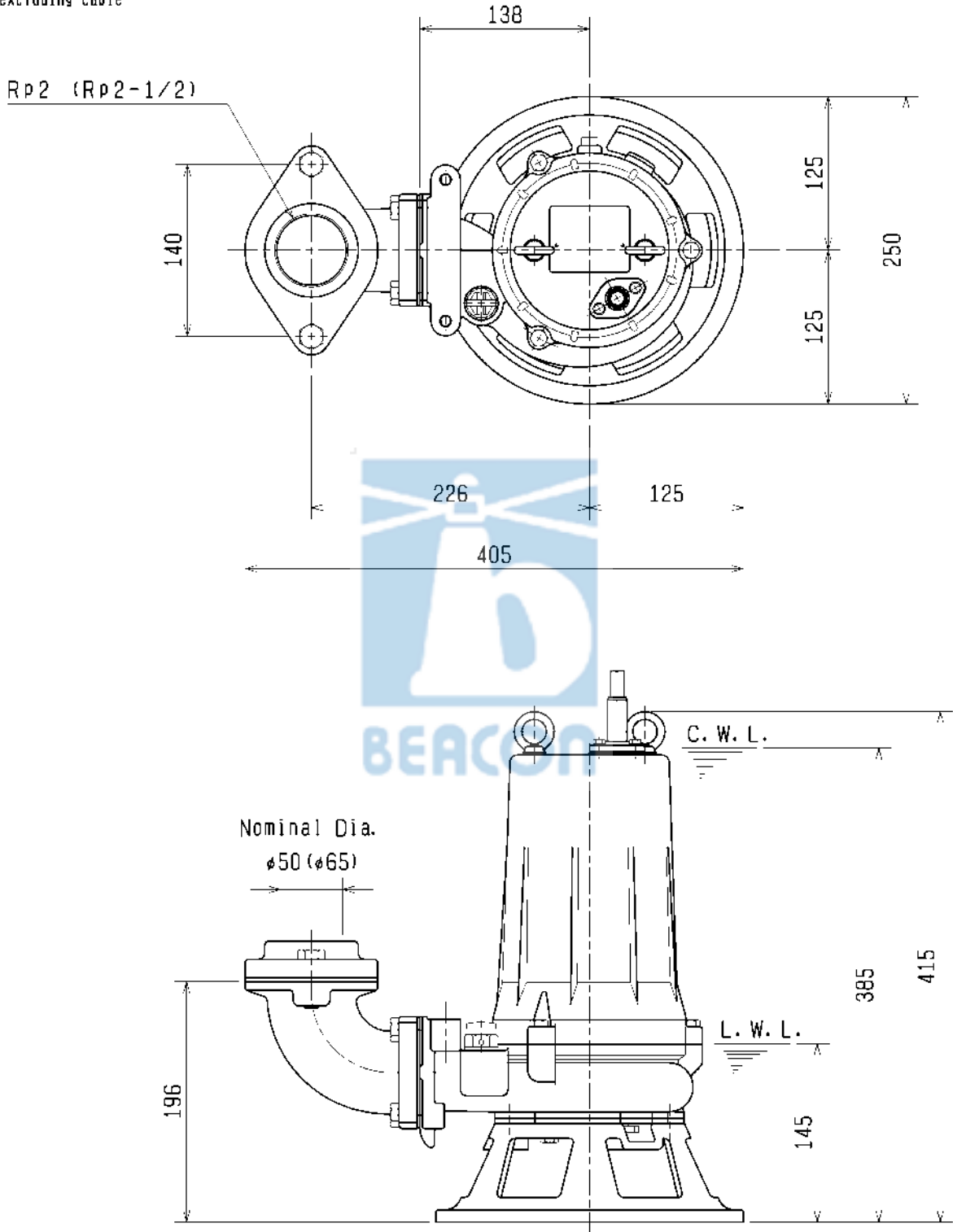

C.W.L.:Continuous running Water Level  
L.W.L.:Lowest running Water Level

<b>SECTIONAL DRAWING</b>		No.	No. A-20065-1
TYPE	Submersible Cutter Sewage Pump	MODEL	50C2.75 -53/63

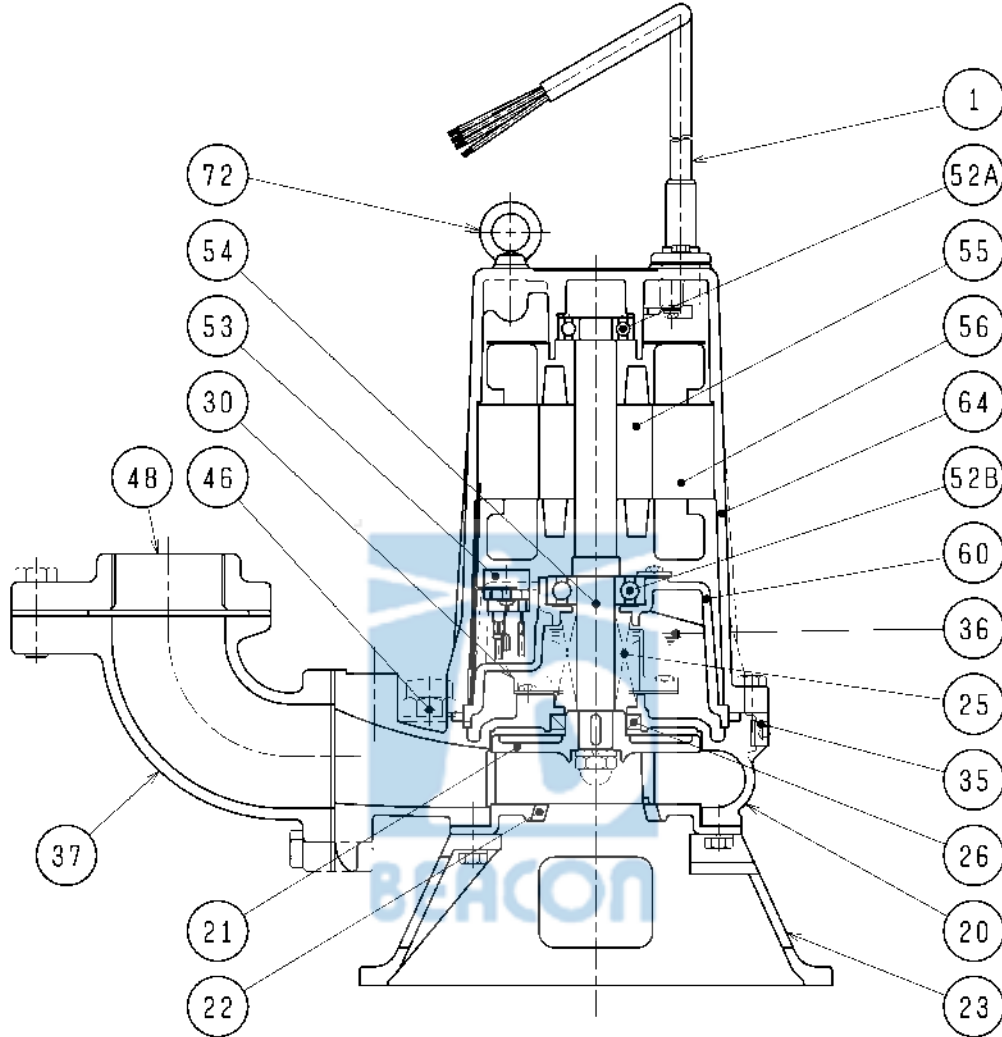

REQ. SPECIFICATION

No.	DESCRIPTION	QTY	MATERIAL / NOTE	No.	DESCRIPTION	QTY	MATERIAL / NOTE
1	Cable	1	PVC Sheath	48	Screwed Flange	1	Gray Iron Casting
20	Pump Casing	1	Gray Iron Casting	52A	Upper Bearing	1	6203ZZC3
21	Impeller	1	Gray Iron Casting (WC Edge)	52B	Lower Bearing	1	6304ZZC3
22	Suction Cover	1	Ductile Iron Casting	53	Motor Protector	1	
23	Strainer Stand	1	Gray Iron Casting	54	Shaft	1	Stainless Steel 420J2
25	Mechanical Seal	1	H-20A	55	Rotor	1	
26	Oil Seal	1	TC32488	56	Stator	1	
30	Oil Lifter	1	Plastic	60	Bearing Housing	1	Gray Iron Casting
35	Oil Plug	1	Stainless Steel 304	64	Motor Frame	1	Gray Iron Casting
36	Lubricant		Turbine Oil (ISO VG32)	72	Eye Bolt	2	Stainless Steel 304
37	Discharge Bend	1	Gray Iron Casting				
46	Air Release Valve	1	Nylon				

NO. A-20448-1

# PUMP PERFORMANCE CURVES

TYPE Sewage Submersible Cutter Pump	MODEL (TOS) 50C2.75S -52 (TOS) 50CA2.75S -52	FREQUENCY 50 Hz
--	---	--------------------

CUSTOMER'S NAME \_\_\_\_\_

EQUIPMENT TITLE \_\_\_\_\_ NO. \_\_\_\_\_

	STANDARD SPECIFICATIONS	REQUIRED SPECIFICATIONS
DISCHARGE BORE	50 mm	mm
TOTAL HEAD	3 m	m
CAPACITY	0.3 m <sup>3</sup> /min	m <sup>3</sup> /min
MOTOR OUTPUT	0.75 kW	kW
PHASE x VOLTAGE	1 φ x V	φ x V
CURRENT	A	A
POLES / REVOLUTION	2 P / S. S. 3000 min <sup>-1</sup>	P / min <sup>-1</sup>
STARTING METHOD	CAPACITOR START	
INSULATION CLASS	E	

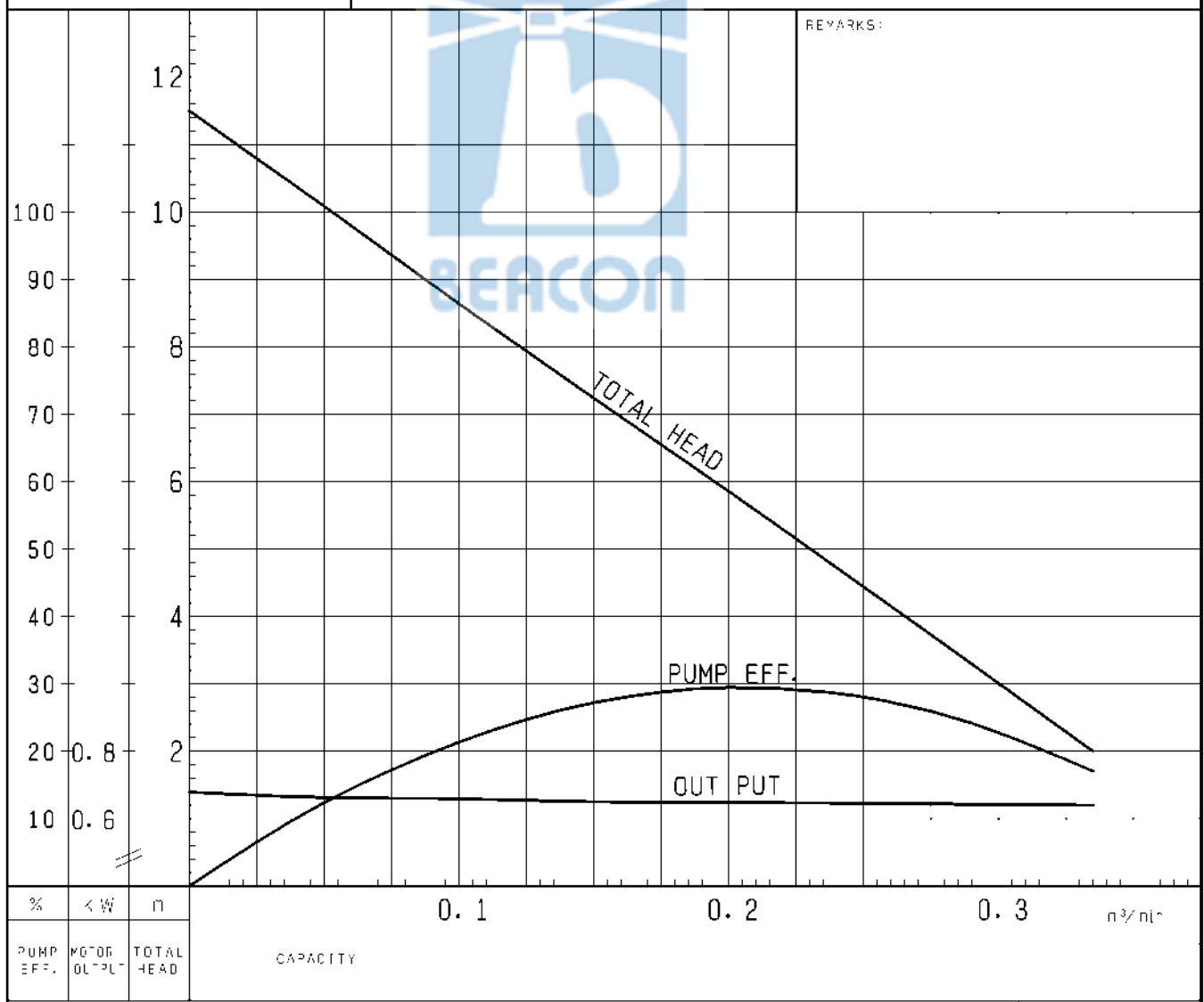

TSURUMI MFG. CO., LTD.

<b>DIMENSION DRAWING</b>		No.	No. A-20450-1
TYPE	Sewage Submersible Cutter Pump	MODEL	50C2.75S -52/62

Approximate Weight (kg)
32kg

\*excluding cable

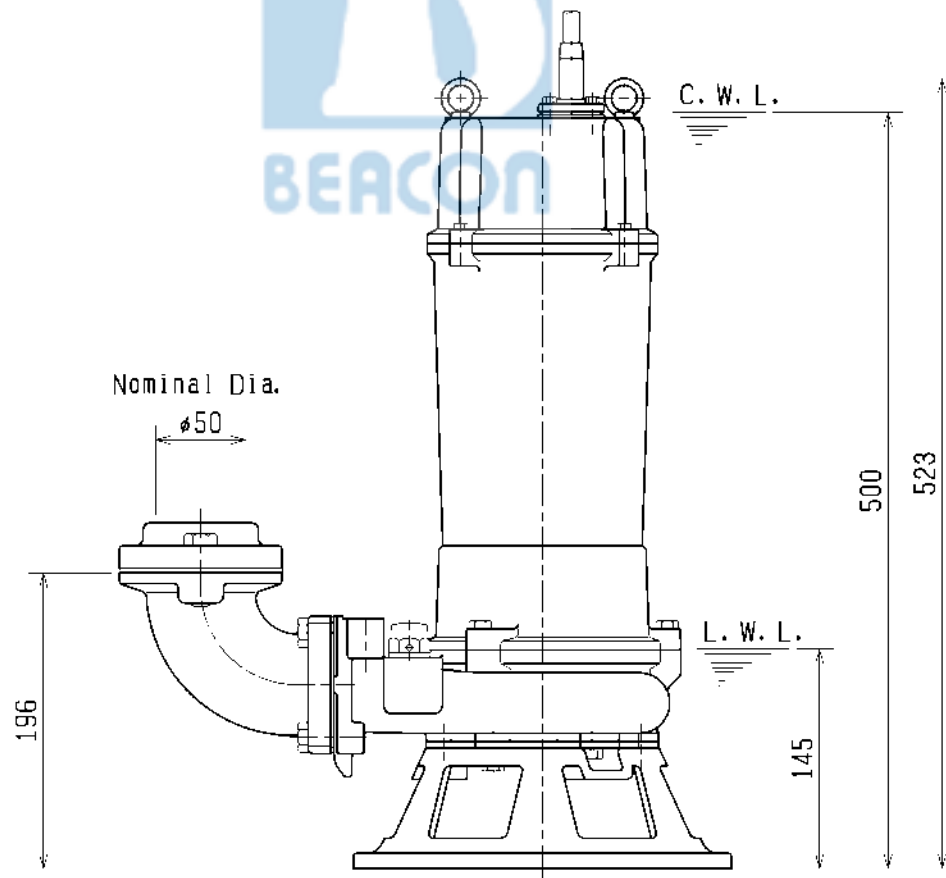
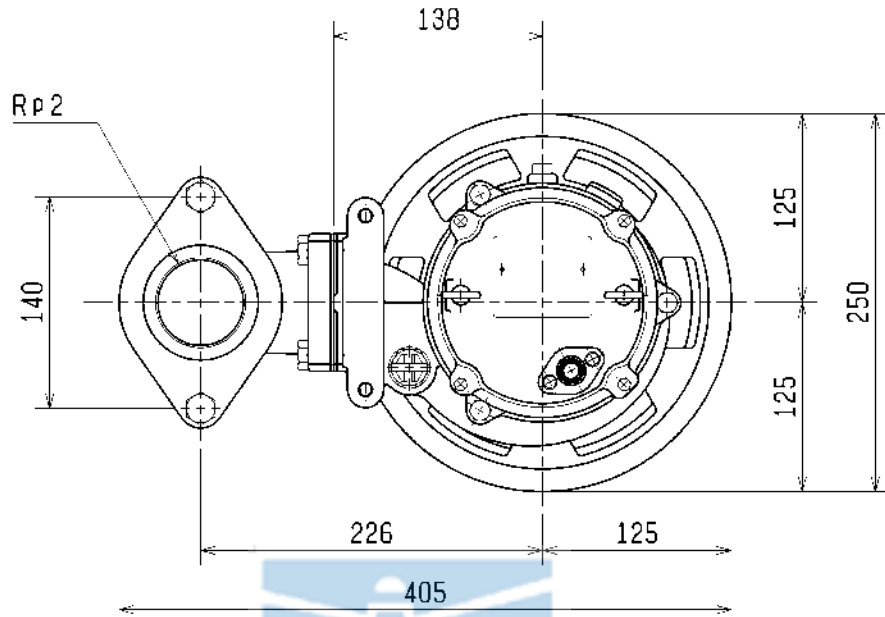

C.W.L. :Continuous running Water Level  
L.W.L. :Lowest running Water Level

<b>SECTIONAL DRAWING</b>		No.	No.	A-20452-1
TYPE	Sewage Submersible Cutter Pump	MODEL	50C2.75S -52/62	

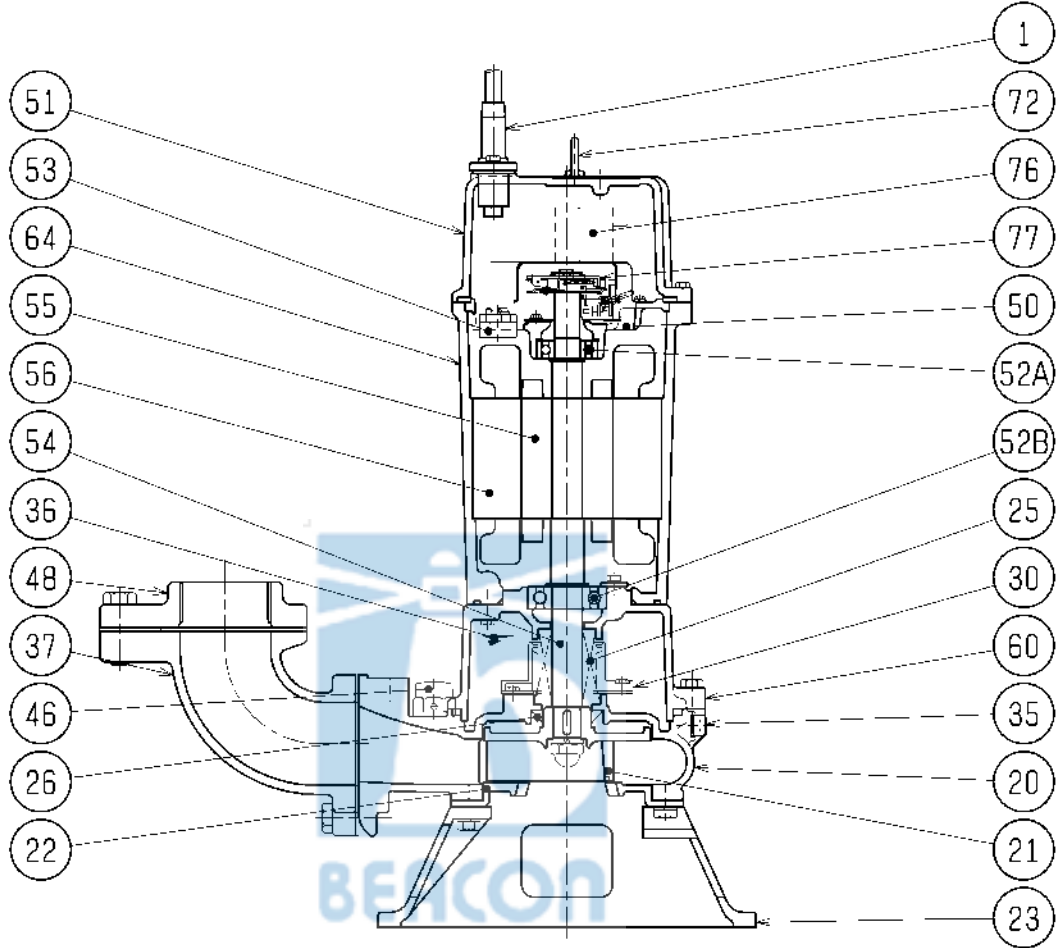

REQ. SPECIFICATION

No.	DESCRIPTION	QTY	MATERIAL / NOTE	No.	DESCRIPTION	QTY	MATERIAL / NOTE
1	Cable	1	PVC Sheath	51	Head Cover	1	Gray Iron Casting
20	Pump Casing	1	Gray Iron Casting	52A	Upper Bearing	1	6203ZC3
21	Impeller	1	Gray Iron Casting(WC Edge)	52B	Lower Bearing	1	6304ZC3
22	Suction Cover	1	Ductile Iron Casting	53	Motor Protector	1	
23	Strainer Stand	1	Gray Iron Casting	54	Shaft	1	Stainless Steel 420J2
25	Mechanical Seal	1	H-20A	55	Rotor	1	
26	Oil Seal	1	TC32488	56	Stator	1	
30	Oil Lifter	1	Plastic	60	Bearing Housing	1	Gray Iron Casting
35	Oil Plug	1	Stainless Steel 304	64	Motor Frame	1	Gray Iron Casting
36	Lubricant		Turbine Oil (ISO VG32)	72	Eye Bolt	2	Stainless Steel 304
37	Discharge Bend	1	Gray Iron Casting	76	Capacitor	1	
46	Air Release Valve	1	Nylon	77	Centrifugal Switch	1	
48	Screwed Flange	1	Gray Iron Casting				
50	Motor Bracket	1	Gray Iron Casting				

NO. A-11470-1

# PUMP PERFORMANCE CURVES

TYPE Sewage Submersible Cutter Pump	MODEL 80C (A/W) 21.5 -52 TOS80C (A/W) 21.5 -52	FREQUENCY 50 Hz
--	---	--------------------

CUSTOMER'S NAME \_\_\_\_\_

EQUIPMENT TITLE \_\_\_\_\_ NO. \_\_\_\_\_

	STANDARD SPECIFICATIONS	REQUIRED SPECIFICATIONS
DISCHARGE BORE	80 mm	mm
TOTAL HEAD	7 m	m
CAPACITY	0.45 m <sup>3</sup> /min	m <sup>3</sup> /min
MOTOR OUTPUT	1.5 kW	kW
PHASE x VOLTAGE	3 $\phi$ x	$\phi$ x V
CURRENT	A	A
POLES / REVOLUTION	2 P / s. s. 3000 min <sup>-1</sup>	P / min <sup>-1</sup>
STARTING METHOD	DIRECT ON LINE	
INSULATION CLASS	F	

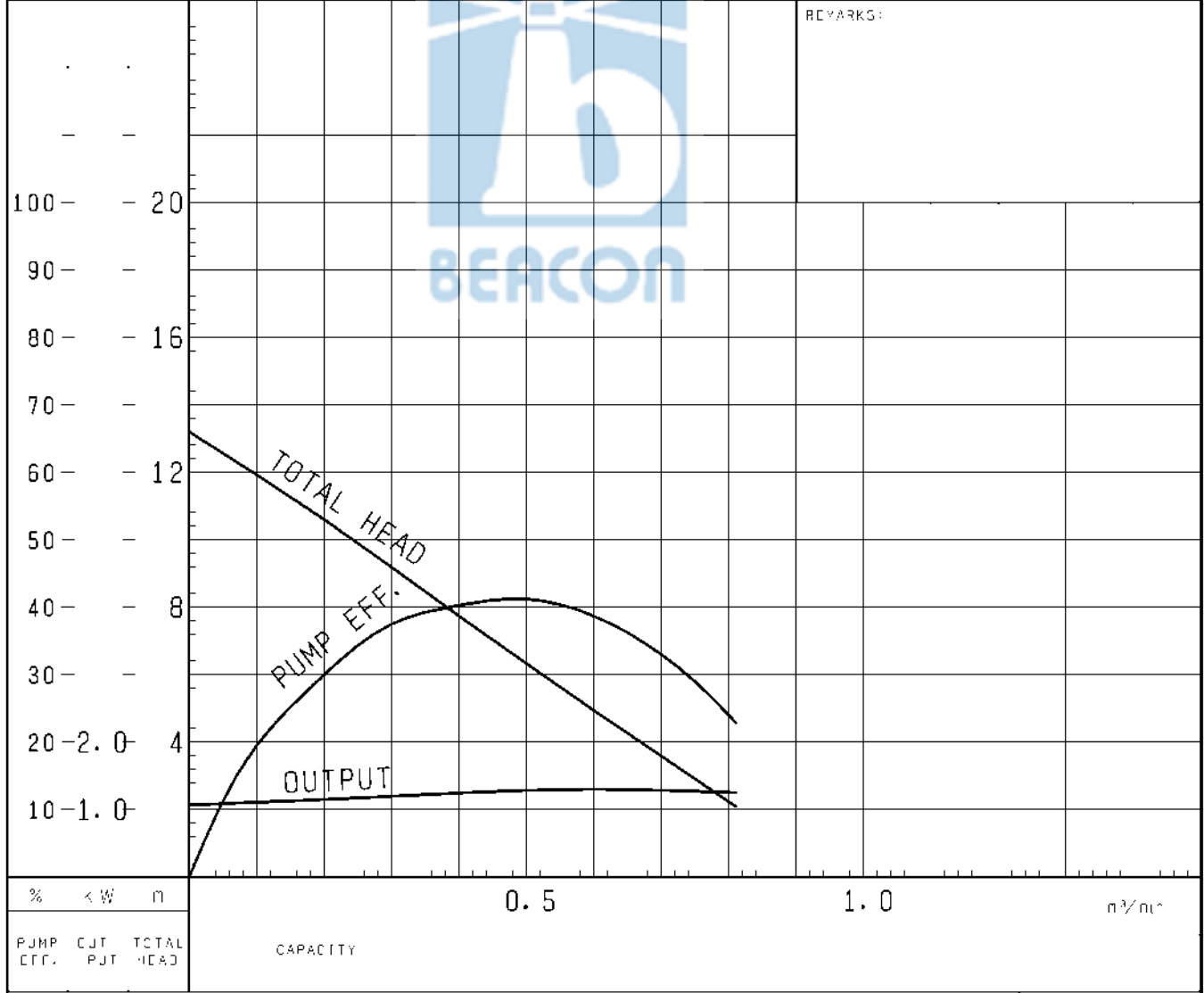

TSURUMI MFG. CO., LTD.

DIMENSION DRAWING		No.	No. A-11472-3
TYPE	Sewage Submersible Cutter Pump	MODEL	80C21.5 -52/62

Approximate Weight(\*)  
36kg  
\*excluding cable

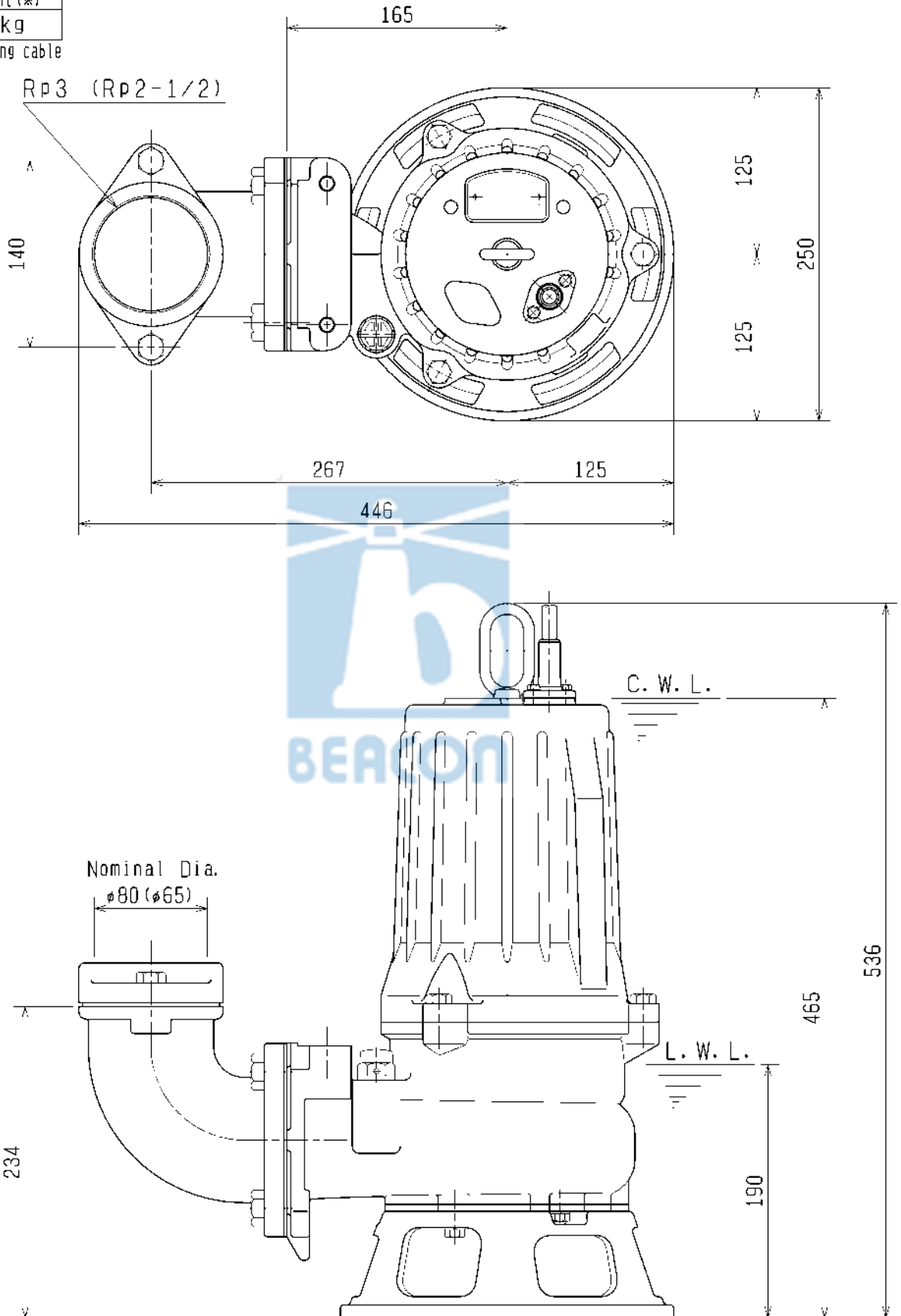

The Figure in ( ) shows the dimensions of discharge Bore at Nominal  $\phi 65$ .

C.W.L. :Continuous running Water Level  
L.W.L. :Lowest running Water Level

<b>SECTIONAL DRAWING</b>		No.	No. A-11475-5
TYPE	Sewage Submersible Cutter Pump	MODEL	80C21.5 -52/62

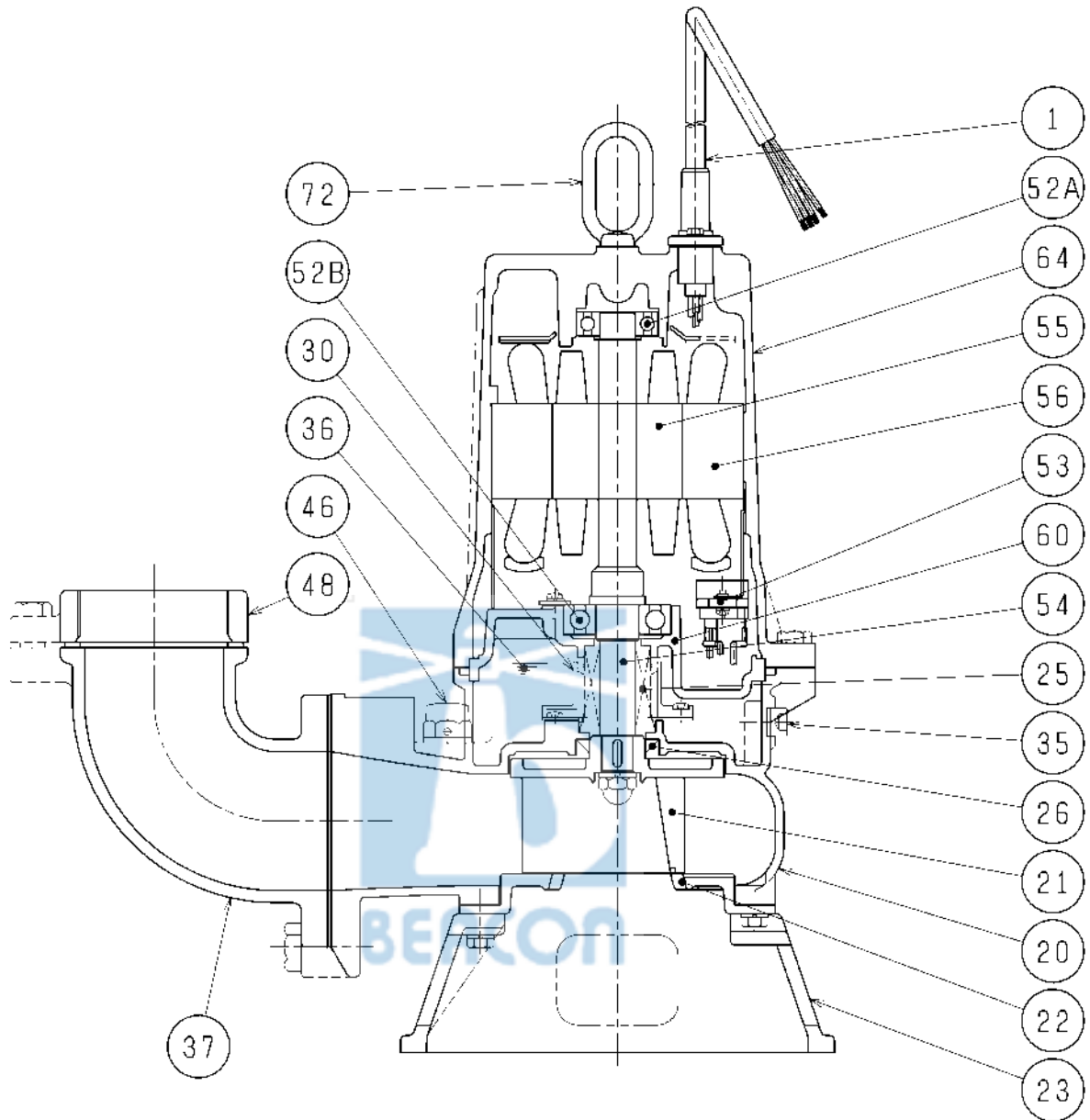

REQ. SPECIFICATION	

※ the wetted part

No.	DESCRIPTION	QTY	MATERIAL / NOTE	No.	DESCRIPTION	QTY	MATERIAL / NOTE
1	Cable	1	PVC Sheath	48	Screwed Flange	1	Gray Iron Casting
20	Pump Casing	1	Gray Iron Casting	52A	Upper Bearing	1	6204ZCC3
21	Impeller	1	Gray Iron Casting(WC Edge)	52B	Lower Bearing	1	6305ZCC3
22	Suction Cover	1	Ductile Iron Casting	53	Motor Protector	1	
23	Strainer Stand	1	Gray Iron Casting	54	Shaft	1	Stainless Steel 420J2(※)
25	Mechanical Seal	1	H-20A	55	Rotor	1	
26	Oil Seal	1	TC32488	56	Stator	1	
30	Oil Lifter	1	Plastic	60	Bearing Housing	1	Gray Iron Casting
35	Oil Plug	1	Stainless Steel 304	64	Motor Frame	1	Gray Iron Casting
36	Lubricant		Turbine Oil (ISO VG32)	72	Eye Bolt	1	Stainless Steel 304
37	Discharge Bend	1	Gray Iron Casting				
46	Air Release Valve	1	Nylon				

NO. A-07849-2

# PUMP PERFORMANCE CURVES

TYPE Submersible Cutter Sewage Pump	MODEL 100C42.2 -52 TOS100C42.2 -52	FREQUENCY 50 Hz
---	--	--------------------

CUSTOMER'S NAME \_\_\_\_\_

EQUIPMENT TITLE \_\_\_\_\_ NO. \_\_\_\_\_

	STANDARD SPECIFICATIONS	REQUIRED SPECIFICATIONS
DISCHARGE BORE	100 mm	mm
TOTAL HEAD	8 m	m
CAPACITY	0.65 m <sup>3</sup> /min	m <sup>3</sup> /min
MOTOR OUTPUT	2.2 kW	kW
PHASE x VOLTAGE	3 $\phi$ x	$\phi$ x V
CURRENT	A	A
POLES / REVOLUTION	4 P / s. s. 1500 min <sup>-1</sup>	P / min <sup>-1</sup>
STARTING METHOD	DIRECT ON LINE	
INSULATION CLASS	E	

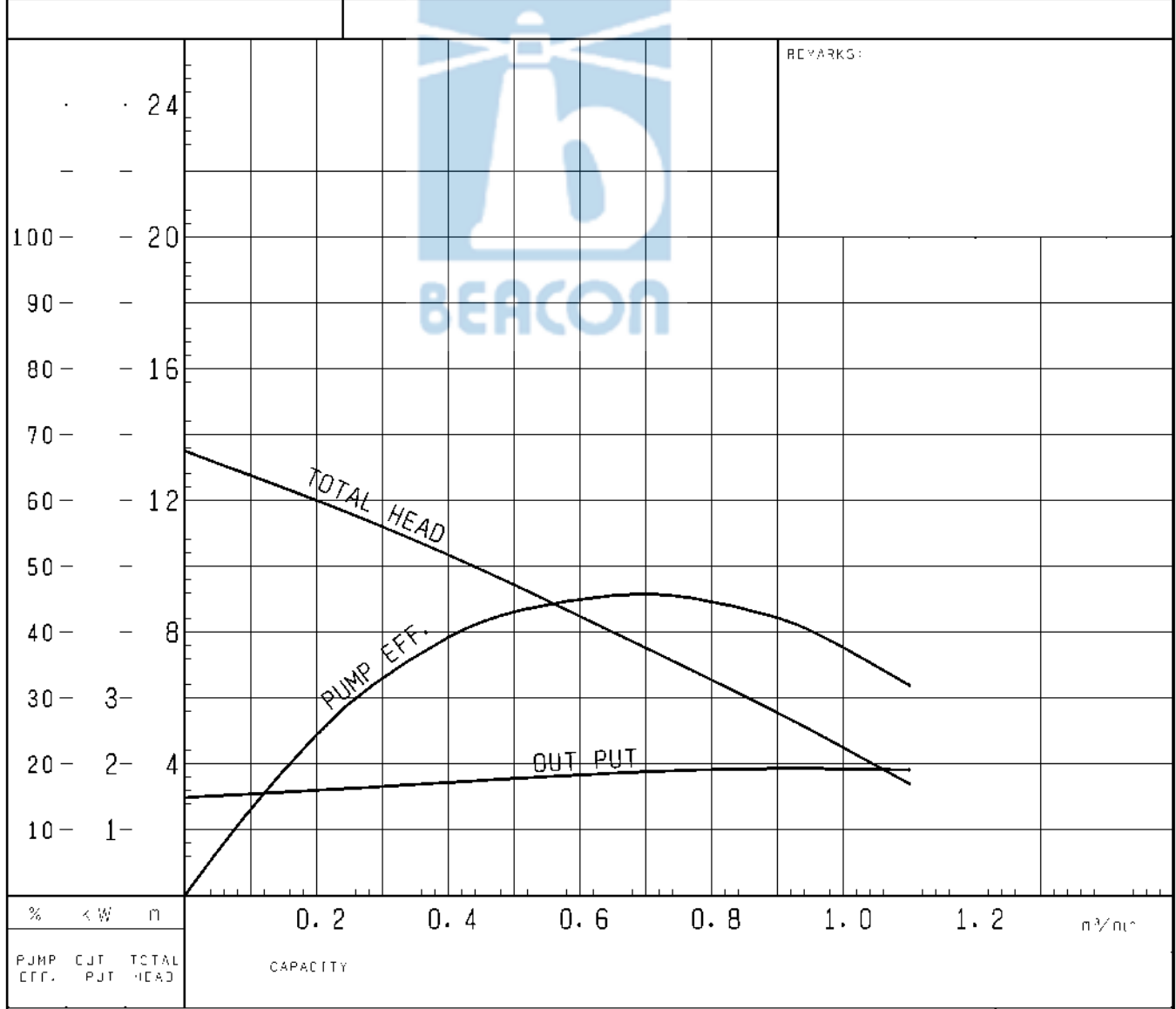

TSURUMI MFG. CO., LTD.

<b>DIMENSION DRAWING</b>		No.	No. A-11703-4
TYPE	Submersible Cutter Sewage Pump	MODEL	100C42.2 -52/62

Approximate Weight (※)  
68kg  
※excluding cable

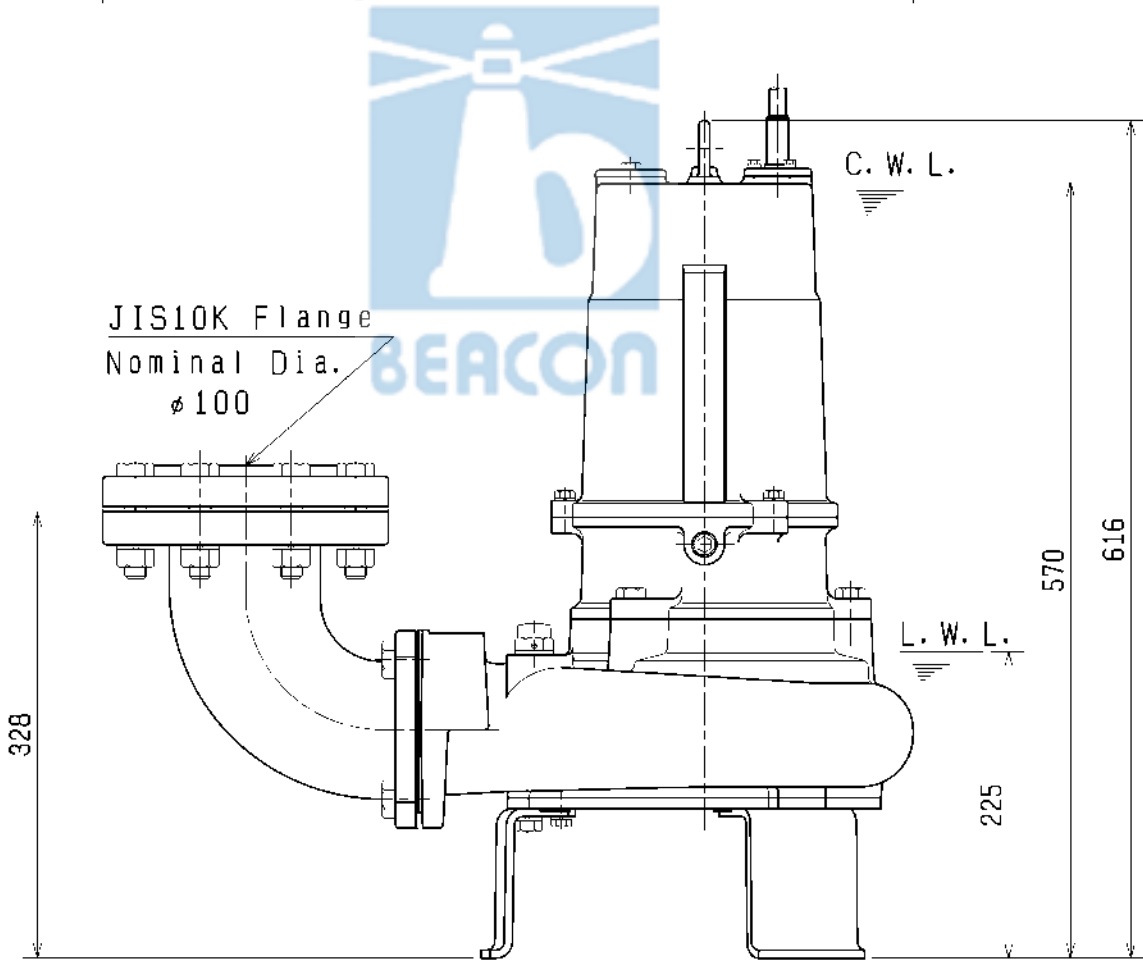
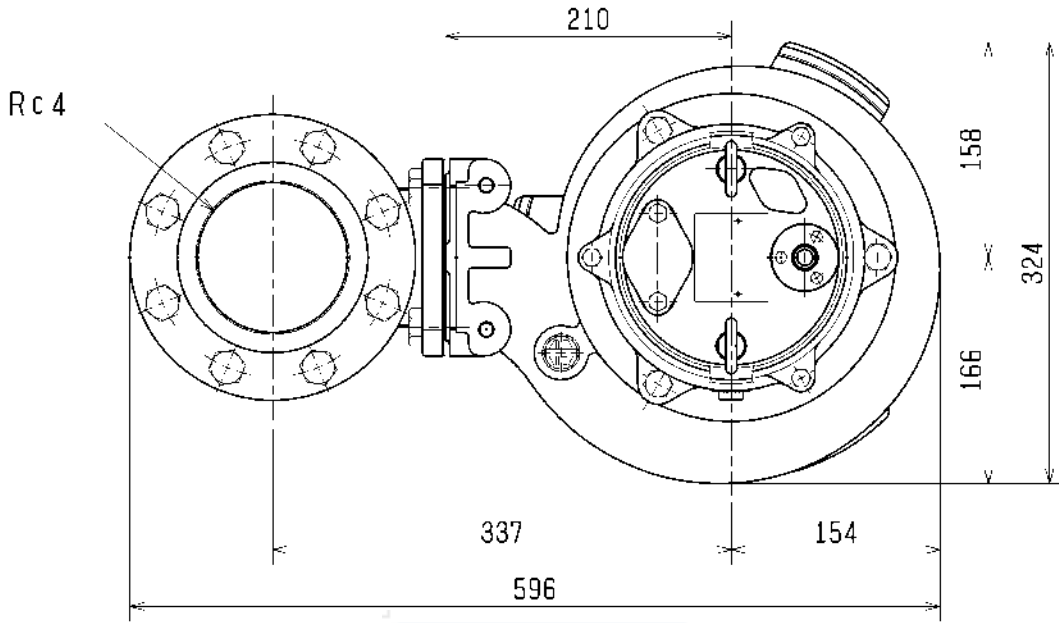

C. W. L. :Continuous running Water Level  
L. W. L. :Lowest running Water Level

<b>SECTIONAL DRAWING</b>		No.	No. A-11710-4
TYPE	Sewage Submersible Cutter Pump	MODEL	100C42.2 -52/62

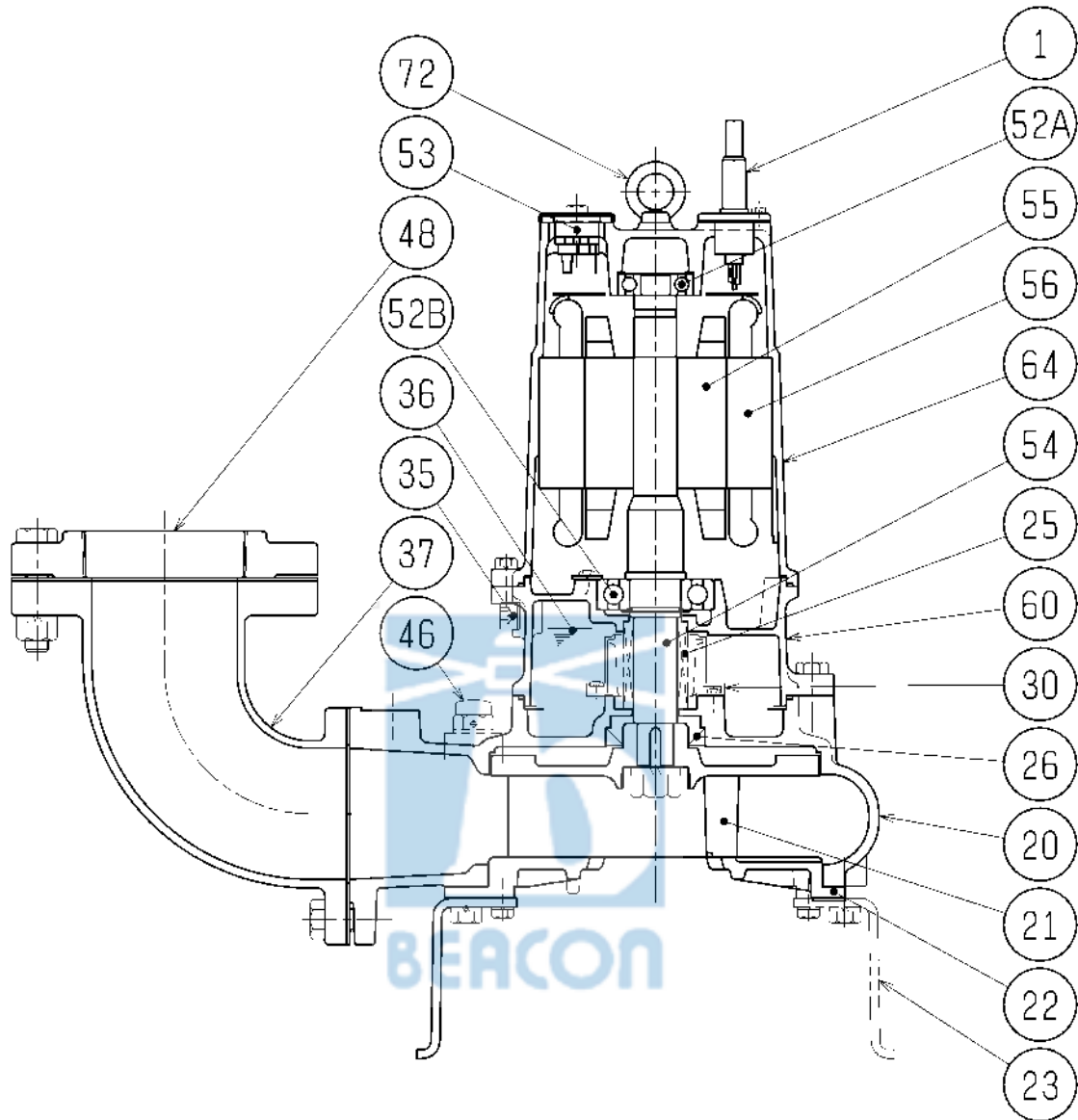

REQ. SPECIFICATION

※ the wetted part

No.	DESCRIPTION	QTY	MATERIAL / NOTE	No.	DESCRIPTION	QTY	MATERIAL / NOTE
1	Cable	1	PVC Sheath	48	Screwed Flange	1	Gray Iron Casting
20	Pump Casing	1	Gray Iron Casting	52A	Upper Bearing	1	6304ZZC3
21	Impeller	1	Gray Iron Casting(WC Edge)	52B	Lower Bearing	1	6307ZZC3
22	Suction Cover	1	Ductile Iron Casting	53	Motor Protector	1	
23	Stand	3	Steel Plate	54	Shaft	1	Stainless Steel 420J2(※)
25	Mechanical Seal	1	H-30A	55	Rotor	1	
26	Oil Seal	1	TC456812	56	Stator	1	
30	Oil Lifter	1	Plastic	60	Bearing Housing	1	Gray Iron Casting
35	Oil Plug	1	Stainless Steel 304	64	Motor Frame	1	Gray Iron Casting
36	Lubricant		Turbine Oil (ISO VG32)	72	Eye Bolt	2	Stainless Steel 304
37	Discharge Bend	1	Gray Iron Casting				
46	Air Release Valve	1	Nylon				



DIMENSION DRAWING		No.	No.
TYPE Submersible Cutter Sewage Pump		MODEL 100C43.7 -53/63	
		No. A-11704-4	

Approximate Weight (kg)  
84kg  
\*excluding cable

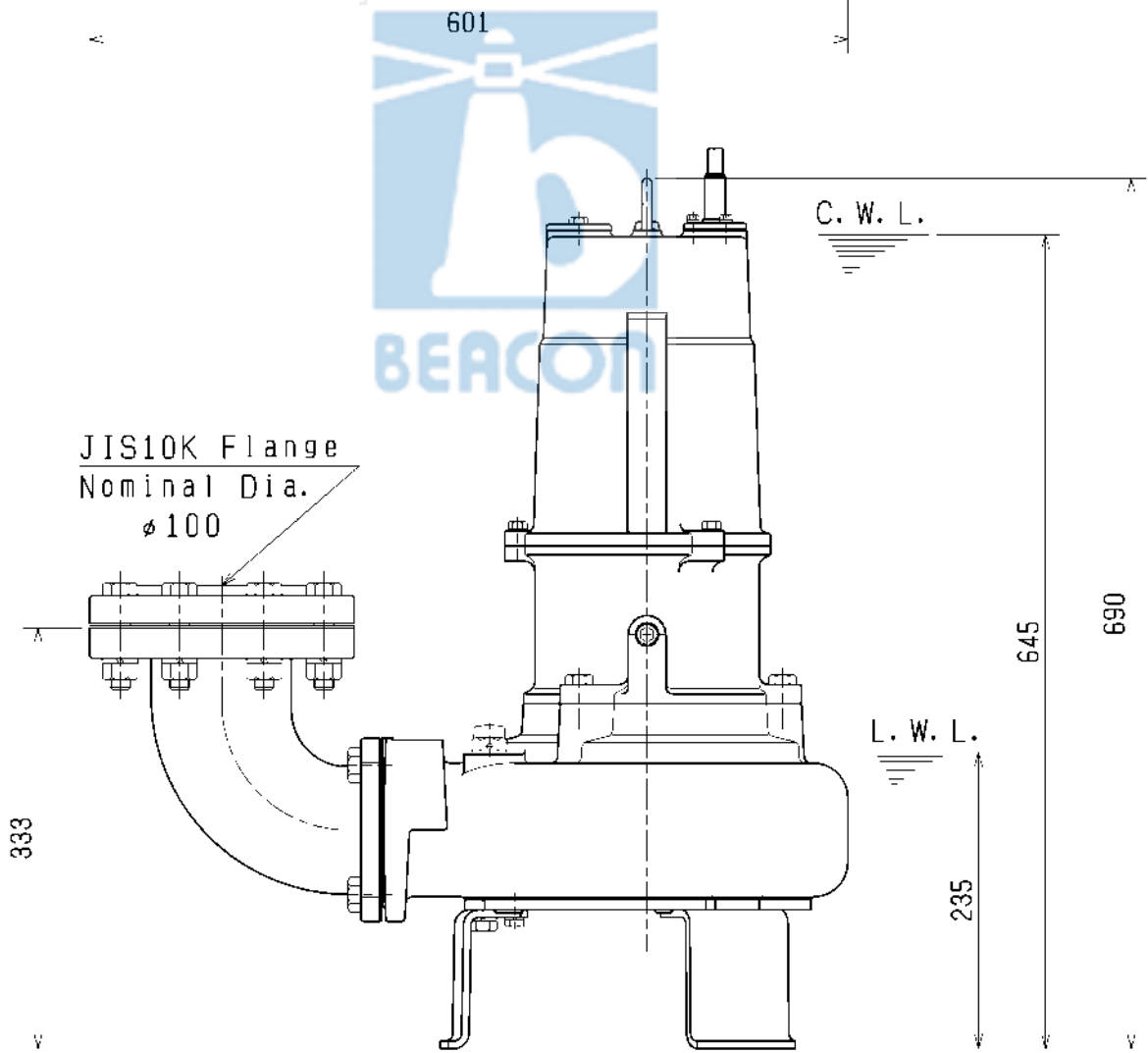
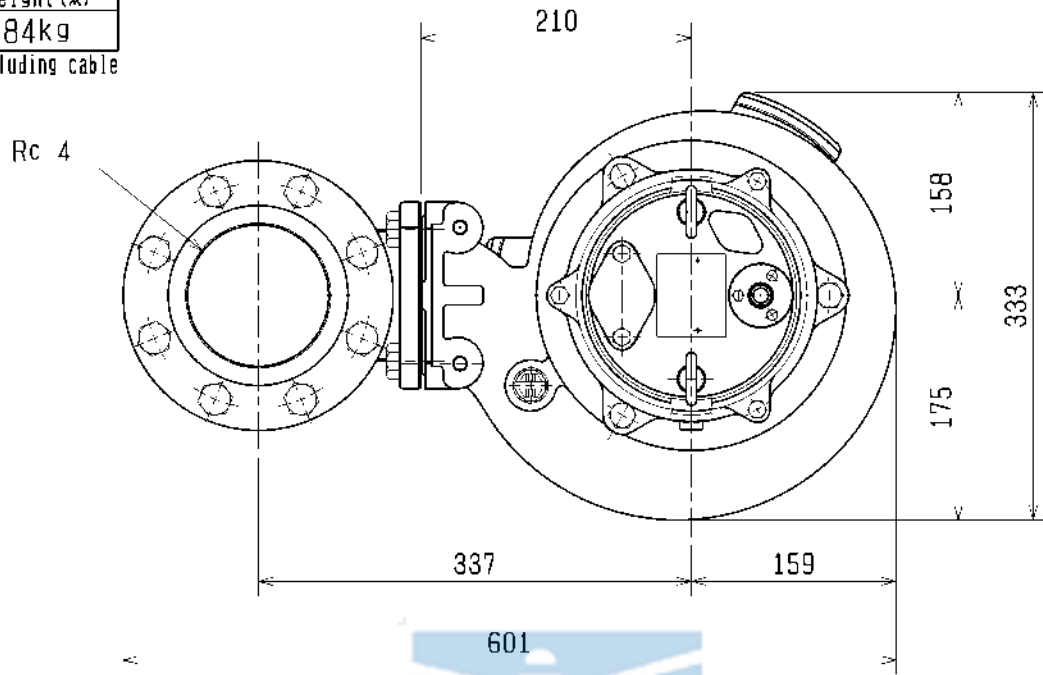

C. W. L. :Continuous running Water Level  
L. W. L. :Lowest running Water Level

<b>SECTIONAL DRAWING</b>		No.	No. A-11711-4
TYPE	Sewage Submersible Cutter Pump	MODEL	100C43.7 -53/63

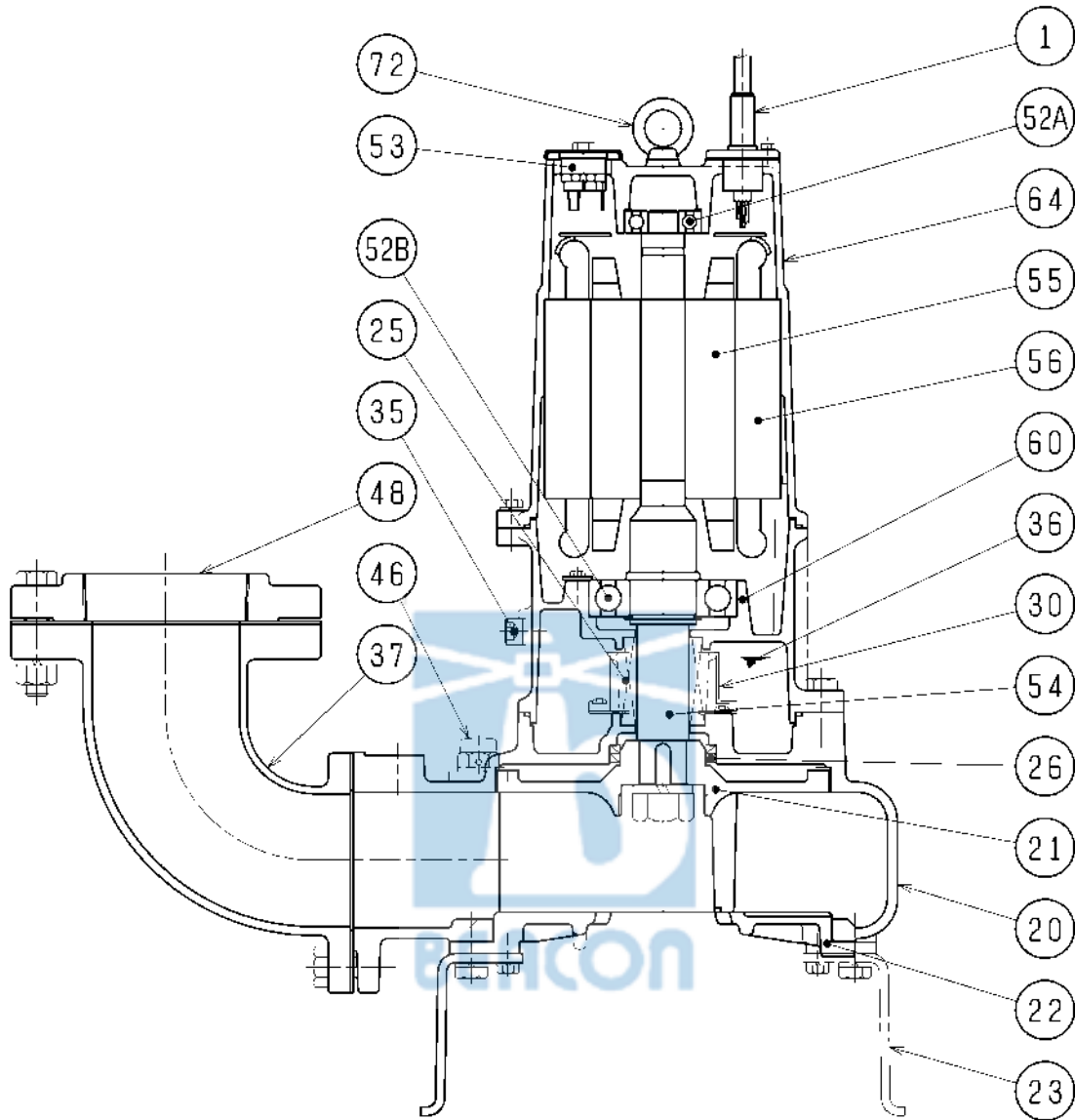

REQ. SPECIFICATION

※ the wetted part

No.	DESCRIPTION	QTY	MATERIAL / NOTE	No.	DESCRIPTION	QTY	MATERIAL / NOTE
1	Cable	1	PVC Sheath	48	Screwed Flange	1	Gray Iron Casting
20	Pump Casing	1	Gray Iron Casting	52A	Upper Bearing	1	6304ZZC3
21	Impeller	1	Gray Iron Casting(WC Edge)	52B	Lower Bearing	1	6309ZZC3
22	Suction Cover	1	Ductile Iron Casting	53	Motor Protector	1	
23	Stand	3	Steel Plate	54	Shaft	1	Stainless Steel 420J2(※)
25	Mechanical Seal	1	H-35A	55	Rotor	1	
26	Oil Seal	2	VC5872G	56	Stator	1	
30	Oil Lifter	1	Plastic	60	Bearing Housing	1	Gray Iron Casting
35	Oil Plug	1	Stainless Steel 304	64	Motor Frame	1	Gray Iron Casting
36	Lubricant		Turbine Oil (ISO VG32)	72	Eye Bolt	2	Stainless Steel 304
37	Discharge Bend	1	Gray Iron Casting				
46	Air Release Valve	1	Nylon				

NO. A-18743-1

# PUMP PERFORMANCE CURVES

TYPE Sewage Submersible Cutter Pump	MODEL 100C45.5 -53 TOS100C45.5 -53	FREQUENCY 50 Hz
--	---------------------------------------	-----------------

CUSTOMER'S NAME \_\_\_\_\_

EQUIPMENT TITLE \_\_\_\_\_ NO. \_\_\_\_\_

	STANDARD SPECIFICATIONS	REQUIRED SPECIFICATIONS
DISCHARGE BORE	100 mm	mm
TOTAL HEAD	13 m	m
CAPACITY	0.8 m <sup>3</sup> /min	m <sup>3</sup> /min
MOTOR OUTPUT	5.5 kW	kW
PHASE x VOLTAGE	3 φ x V	φ x V
CURRENT	A	A
POLES / REVOLUTION	4 P / s. s. 1500 min <sup>-1</sup>	P / min <sup>-1</sup>
STARTING METHOD	DIRECT ON LINE	
INSULATION CLASS	F	

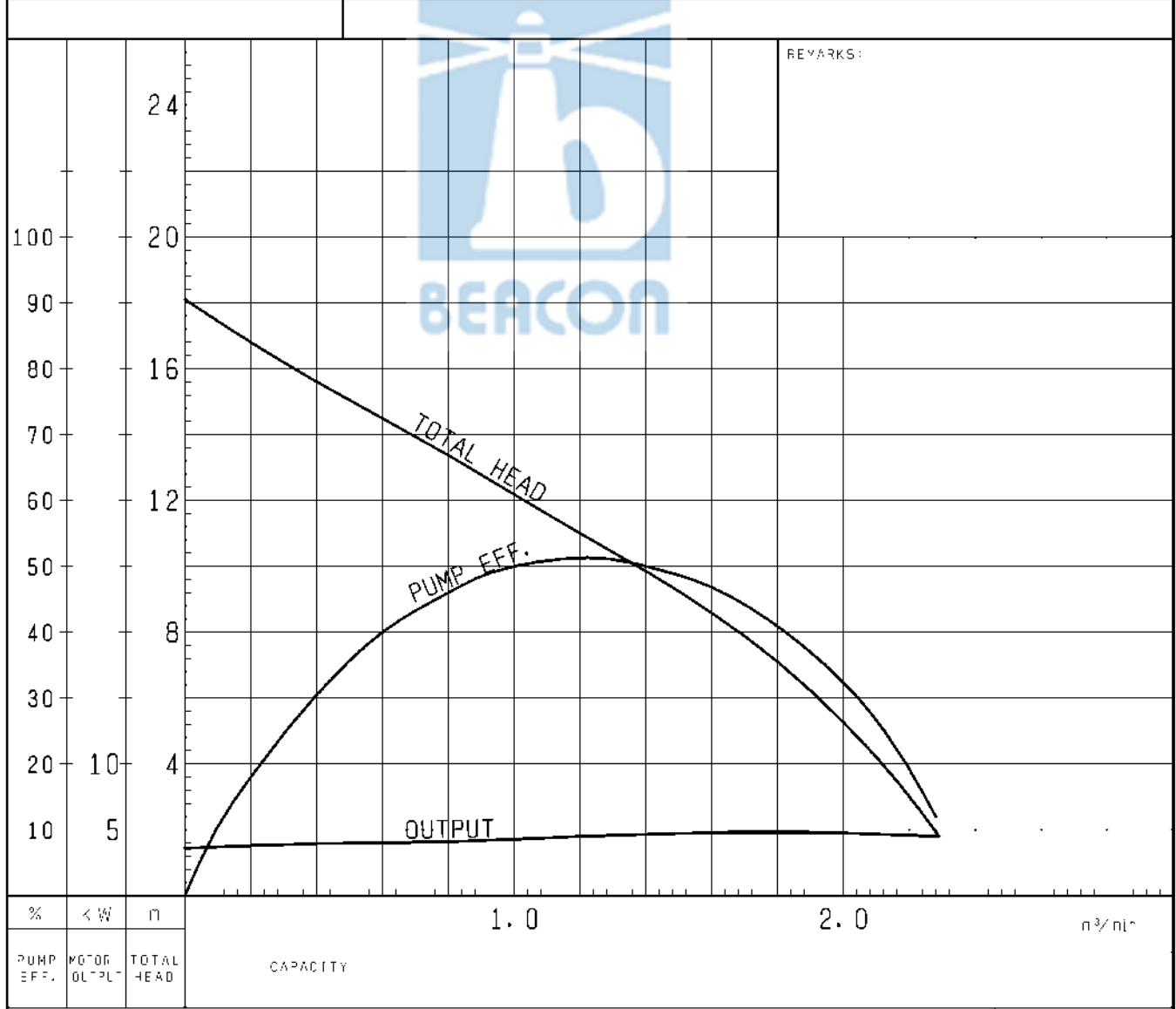

TSURUMI MFG. CO., LTD.

DIMENSION DRAWING		No.	No.	A-18781-1
TYPE	Sewage Submersible Cutter Pump	MODEL	100C45.5 -53/63 100C47.5 -53/63	

MODEL	W1	H	Approximate Weight (kg)
100C45.5-53/63	775	908	140kg
100C47.5-53/63	800	929	159kg

\*excluding cable

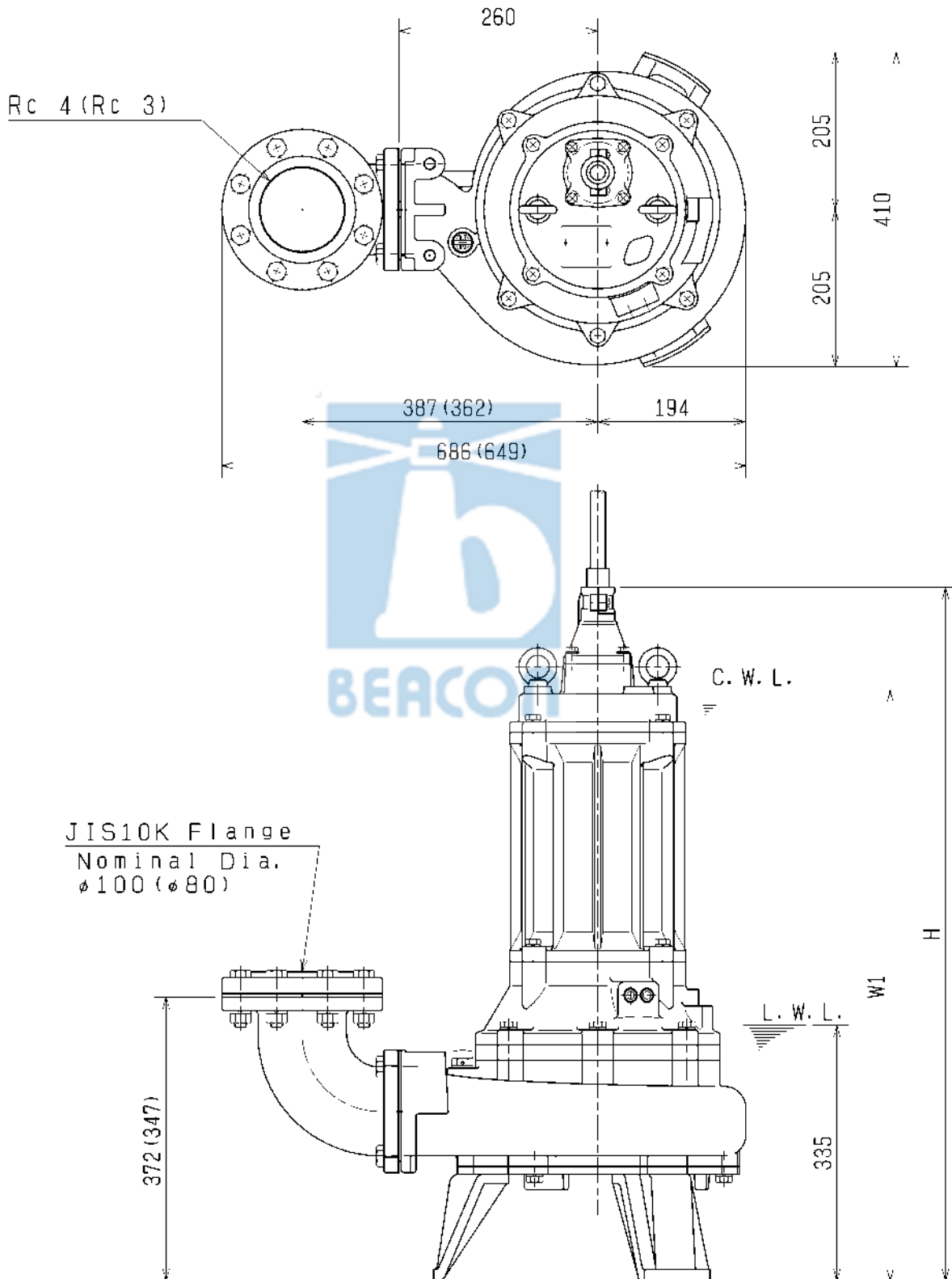

The Figure in ( ) shows the dimensions of discharge Bore at Nominal  $\phi 80$ .

C.W.L. :Continuous running Water Level  
L.W.L. :Lowest running Water Level

<b>SECTIONAL DRAWING</b>		No.	No. A-18798-1
TYPE	Sewage Submersible Cutter Pump	MODEL	100C45.5 -53/63 100C47.5 -53/63

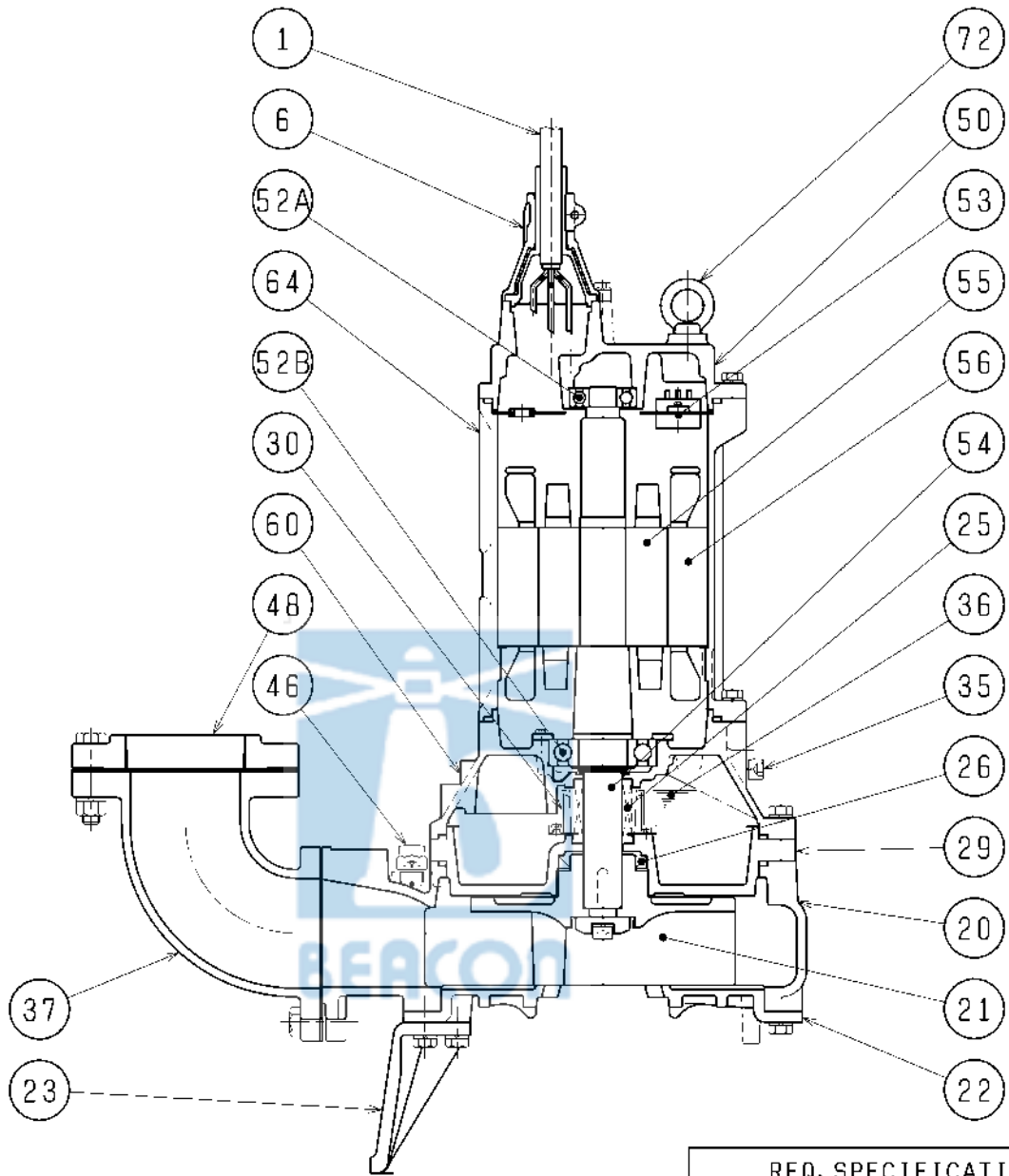

REQ. SPECIFICATION	

	*1
5.5kW	6305ZZC3
7.5kW	6306ZZC3

No.	DESCRIPTION	QTY	MATERIAL / NOTE	No.	DESCRIPTION	QTY	MATERIAL / NOTE
1	Cabtyre Cable	1	Chloroprene Sheath	48	Screwed Flange	1	Gray Iron Casting
6	Stuffing Box	1	Gray Iron Casting	50	Motor Bracket	1	Gray Iron Casting
20	Pump Casing	1	Gray Iron Casting	52A	Upper Bearing	1	*1
21	Impeller	1	Gray Iron Casting (WC Edge)	52B	Lower Bearing	1	6309ZZC3
22	Suction Cover	1	Ductile Iron Casting	53	Motor Protector	1	
23	Stand	3	Gray Iron Casting	54	Shaft	1	Stainless Steel 420J2
25	Mechanical Seal	1	H-35A	55	Rotor	1	
26	Oil Seal	1	TC608212	56	Stator	1	
29	Oil Casing	1	Gray Iron Casting	60	Bearing Housing	1	Gray Iron Casting
30	Oil Lifter	1	Plastic	64	Motor Frame	1	Gray Iron Casting
35	Oil Plug	2	Stainless Steel 304	72	Eye Bolt	2	Structure Steel
36	Lubricant		Turbine Oil (ISO VG32)				
37	Discharge Bend	1	Gray Iron Casting				
46	Air Release Valve	1	Nylon				

NO. A-18745-1

# PUMP PERFORMANCE CURVES

TYPE Sewage Submersible Cutter Pump	MODEL 100C47.5 -53 TOS100C47.5 -53	FREQUENCY 50 Hz
--	---------------------------------------	-----------------

CUSTOMER'S NAME \_\_\_\_\_

EQUIPMENT TITLE \_\_\_\_\_ NO. \_\_\_\_\_

	STANDARD SPECIFICATIONS	REQUIRED SPECIFICATIONS
DISCHARGE BORE	100 mm	mm
TOTAL HEAD	16 m	m
CAPACITY	0.8 m <sup>3</sup> /min	m <sup>3</sup> /min
MOTOR OUTPUT	7.5 kW	kW
PHASE x VOLTAGE	3 φ x V	φ x V
CURRENT	A	A
POLES / REVOLUTION	4 P / s. s. 1500 min <sup>-1</sup>	P / min <sup>-1</sup>
STARTING METHOD	DIRECT ON LINE	
INSULATION CLASS	F	

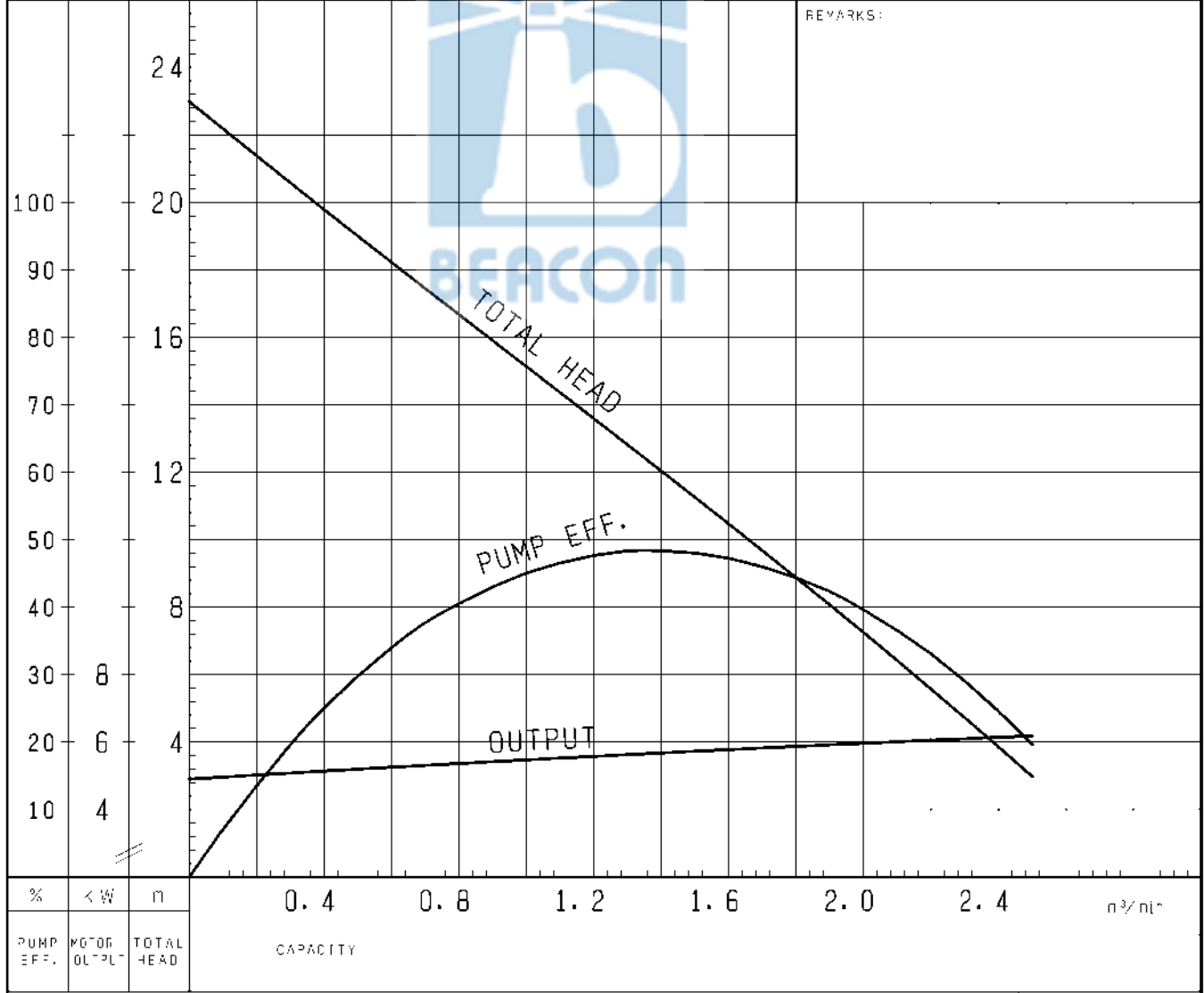

TSURUMI MFG. CO., LTD.

DIMENSION DRAWING		No.	No.	A-18781-1
TYPE	Sewage Submersible Cutter Pump	MODEL	100C45.5 -53/63 100C47.5 -53/63	

MODEL	W1	H	Approximate Weight (kg)
100C45.5-53/63	775	908	140kg
100C47.5-53/63	800	929	159kg

\*excluding cable

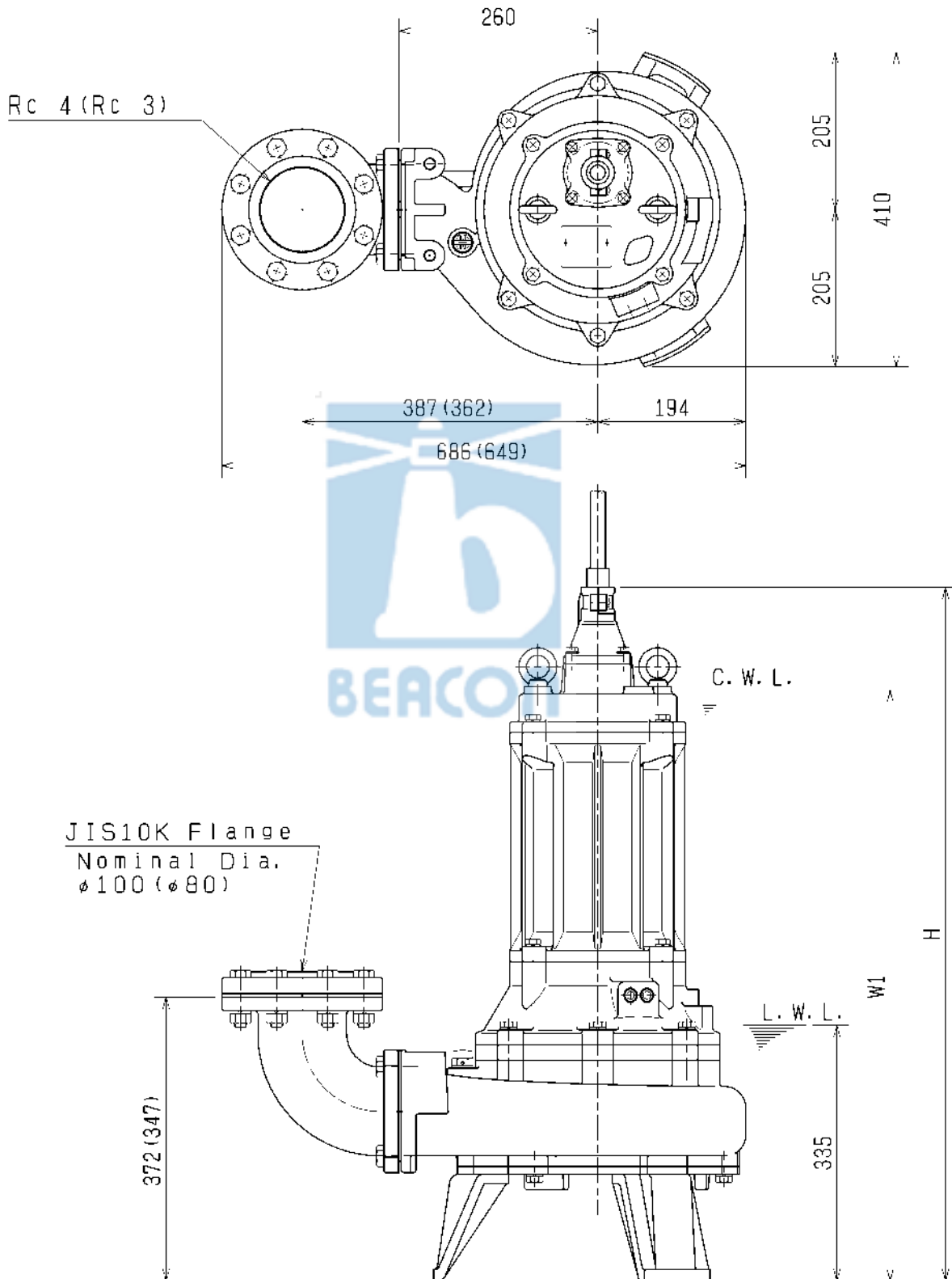

The Figure in ( ) shows the dimensions of discharge Bore at Nominal φ80.

C.W.L. : Continuous running Water Level  
L.W.L. : Lowest running Water Level

<b>SECTIONAL DRAWING</b>		No.	No. A-18798-1
TYPE	Sewage Submersible Cutter Pump	MODEL	100C45.5 -53/63 100C47.5 -53/63

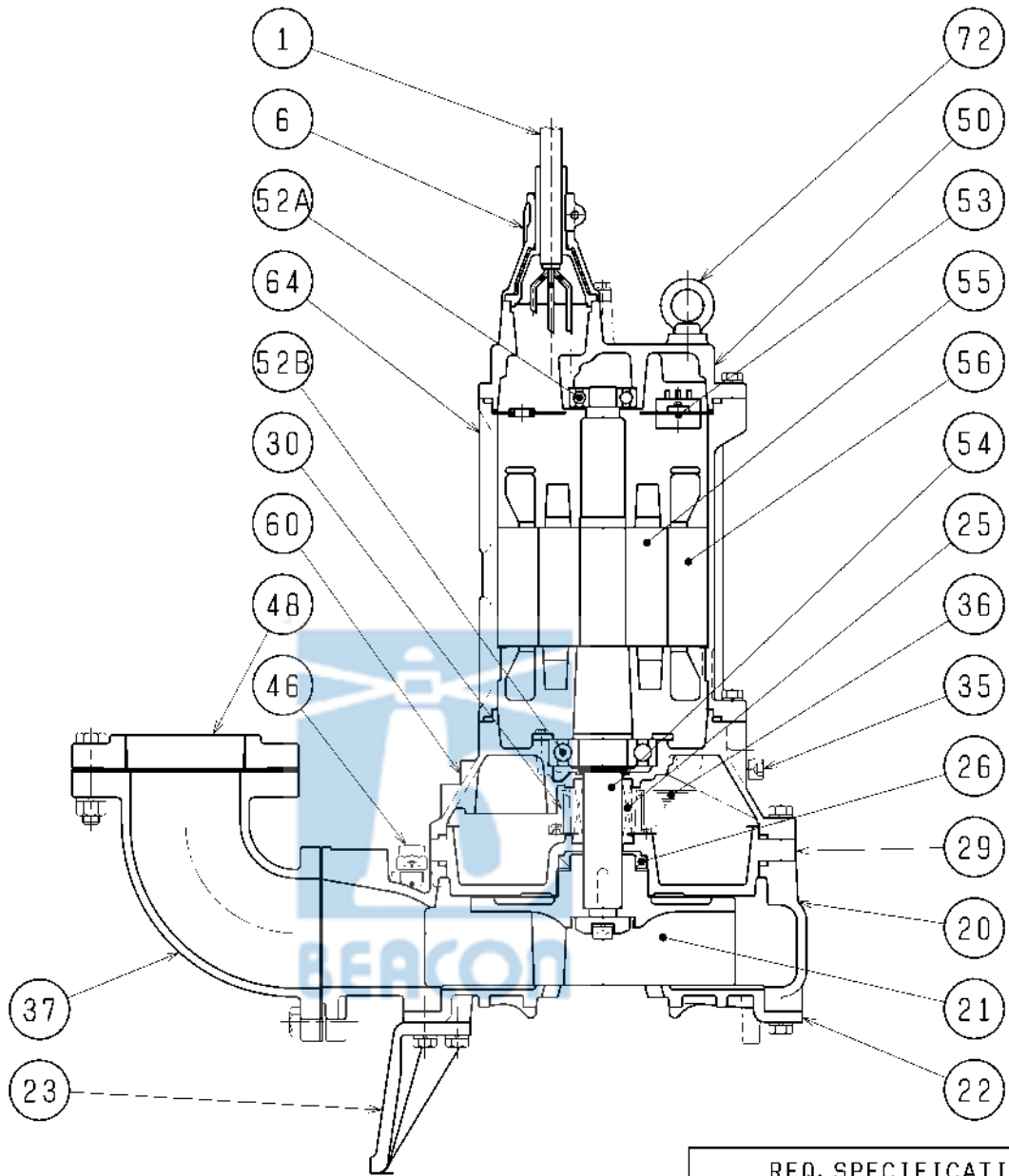

REQ. SPECIFICATION	

	*1
5.5kW	6305ZZC3
7.5kW	6306ZZC3

No.	DESCRIPTION	QTY	MATERIAL / NOTE	No.	DESCRIPTION	QTY	MATERIAL / NOTE
1	Cabtyre Cable	1	Chloroprene Sheath	48	Screwed Flange	1	Gray Iron Casting
6	Stuffing Box	1	Gray Iron Casting	50	Motor Bracket	1	Gray Iron Casting
20	Pump Casing	1	Gray Iron Casting	52A	Upper Bearing	1	*1
21	Impeller	1	Gray Iron Casting (WC Edge)	52B	Lower Bearing	1	6309ZZC3
22	Suction Cover	1	Ductile Iron Casting	53	Motor Protector	1	
23	Stand	3	Gray Iron Casting	54	Shaft	1	Stainless Steel 420J2
25	Mechanical Seal	1	H-35A	55	Rotor	1	
26	Oil Seal	1	TC608212	56	Stator	1	
29	Oil Casing	1	Gray Iron Casting	60	Bearing Housing	1	Gray Iron Casting
30	Oil Lifter	1	Plastic	64	Motor Frame	1	Gray Iron Casting
35	Oil Plug	2	Stainless Steel 304	72	Eye Bolt	2	Structure Steel
36	Lubricant		Turbine Oil (ISO VG32)				
37	Discharge Bend	1	Gray Iron Casting				
46	Air Release Valve	1	Nylon				

NO. A-18747-1

# PUMP PERFORMANCE CURVES

TYPE Sewage Submersible Cutter Pump	MODEL 100C411 -53 TOS100C411 -53	FREQUENCY 50 Hz
--	-------------------------------------	-----------------

CUSTOMER'S NAME \_\_\_\_\_

EQUIPMENT TITLE \_\_\_\_\_ NO. \_\_\_\_\_

	STANDARD SPECIFICATIONS	REQUIRED SPECIFICATIONS
DISCHARGE BORE	100 mm	mm
TOTAL HEAD	20 m	m
CAPACITY	0.8 m <sup>3</sup> /min	m <sup>3</sup> /min
MOTOR OUTPUT	11 kW	kW
PHASE x VOLTAGE	3 $\phi$ x V	$\phi$ x V
CURRENT	A	A
POLES / REVOLUTION	4 P / s. s. 1500 min <sup>-1</sup>	P / min <sup>-1</sup>
STARTING METHOD	STAR-DELTA	
INSULATION CLASS	F	

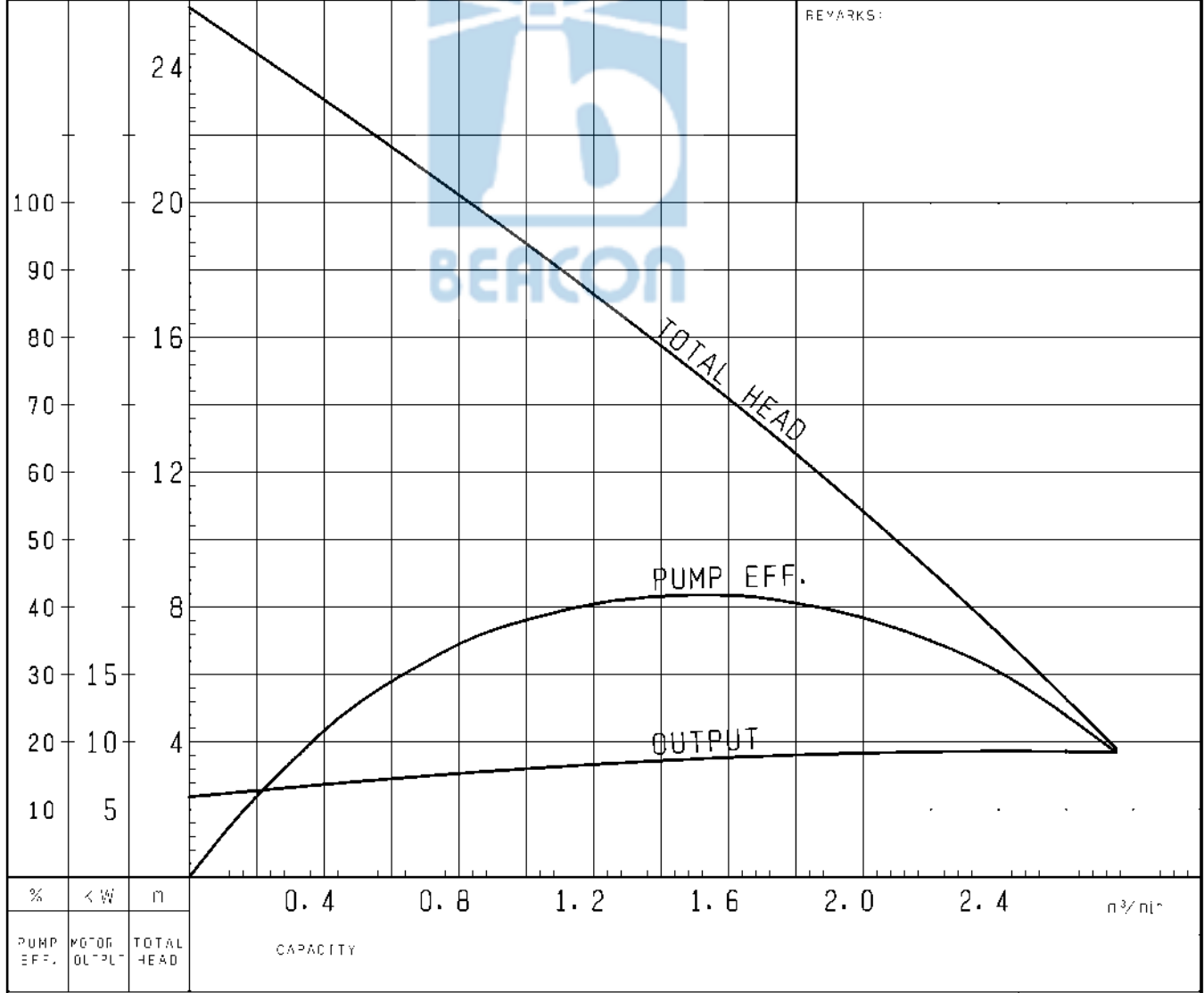

TSURUMI MFG. CO., LTD.

DIMENSION DRAWING		No.	No. A-18782-1
TYPE	Sewage Submersible Cutter Pump	MODEL	100C411 -53/63

Approximate Weight(*)
184kg
*excluding cable

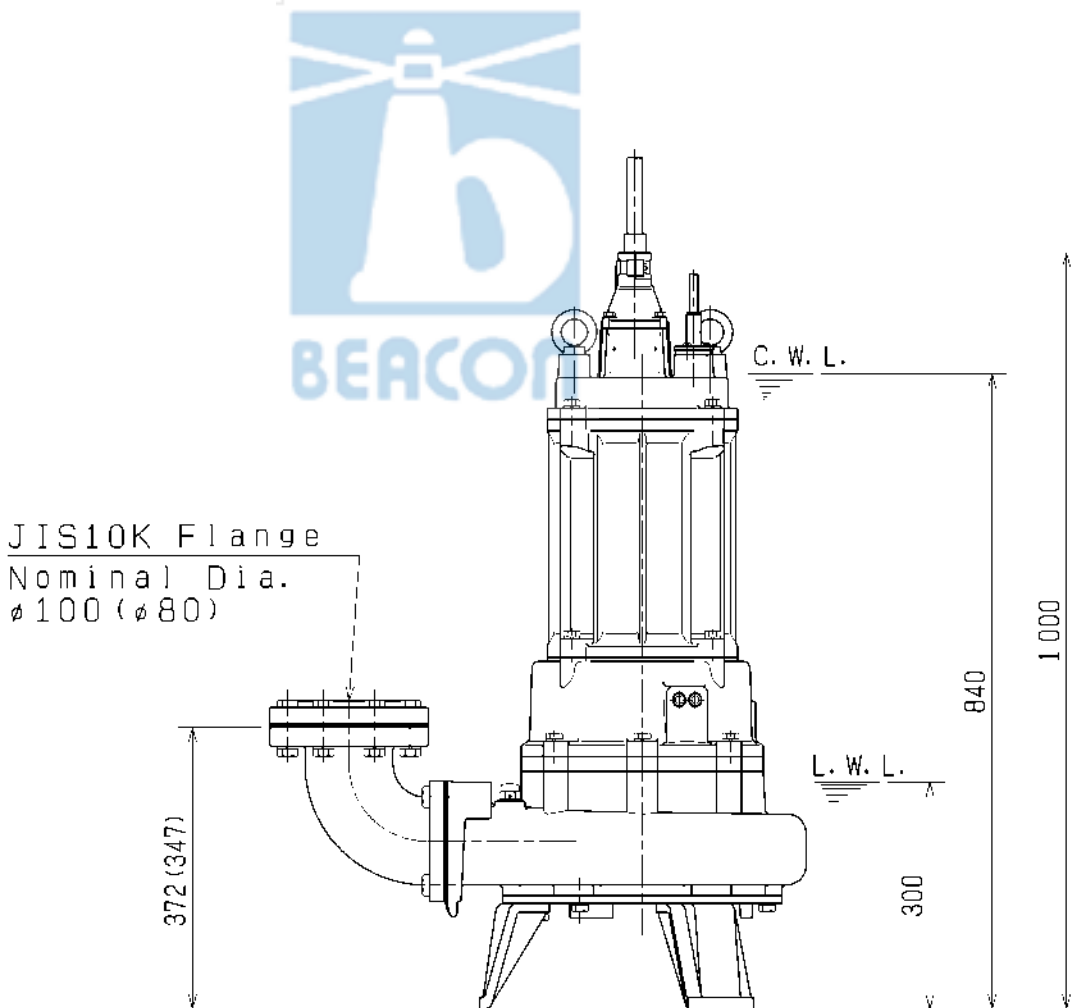
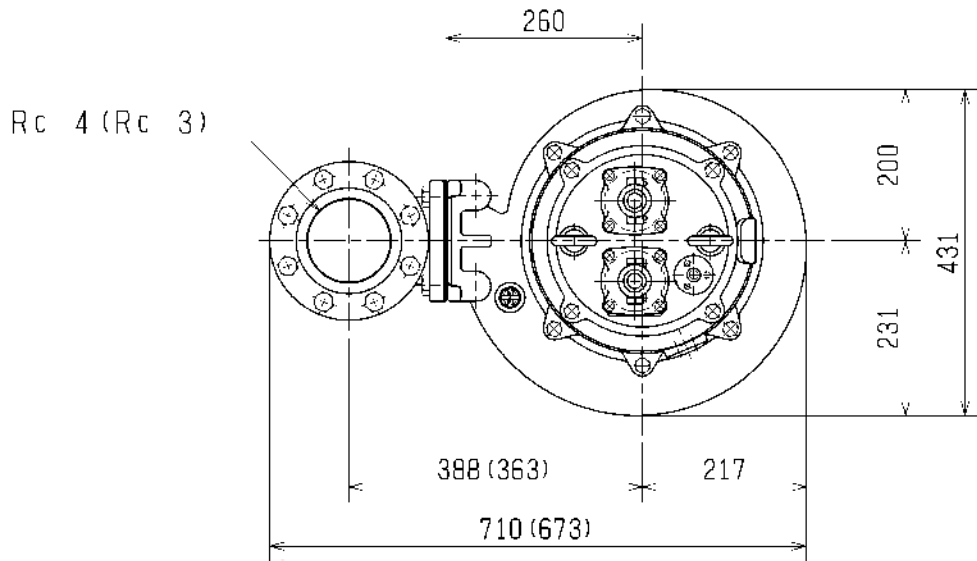

The Figure in ( ) shows the dimensions of discharge Bore at Nominal  $\phi 80$ .

C.W.L.:Continuous running Water Level  
L.W.L.:Lowest running Water Level

<b>SECTIONAL DRAWING</b>		No.	No. A-18799-1
TYPE	Sewage Submersible Cutter Pump	MODEL	100C411 -53/63

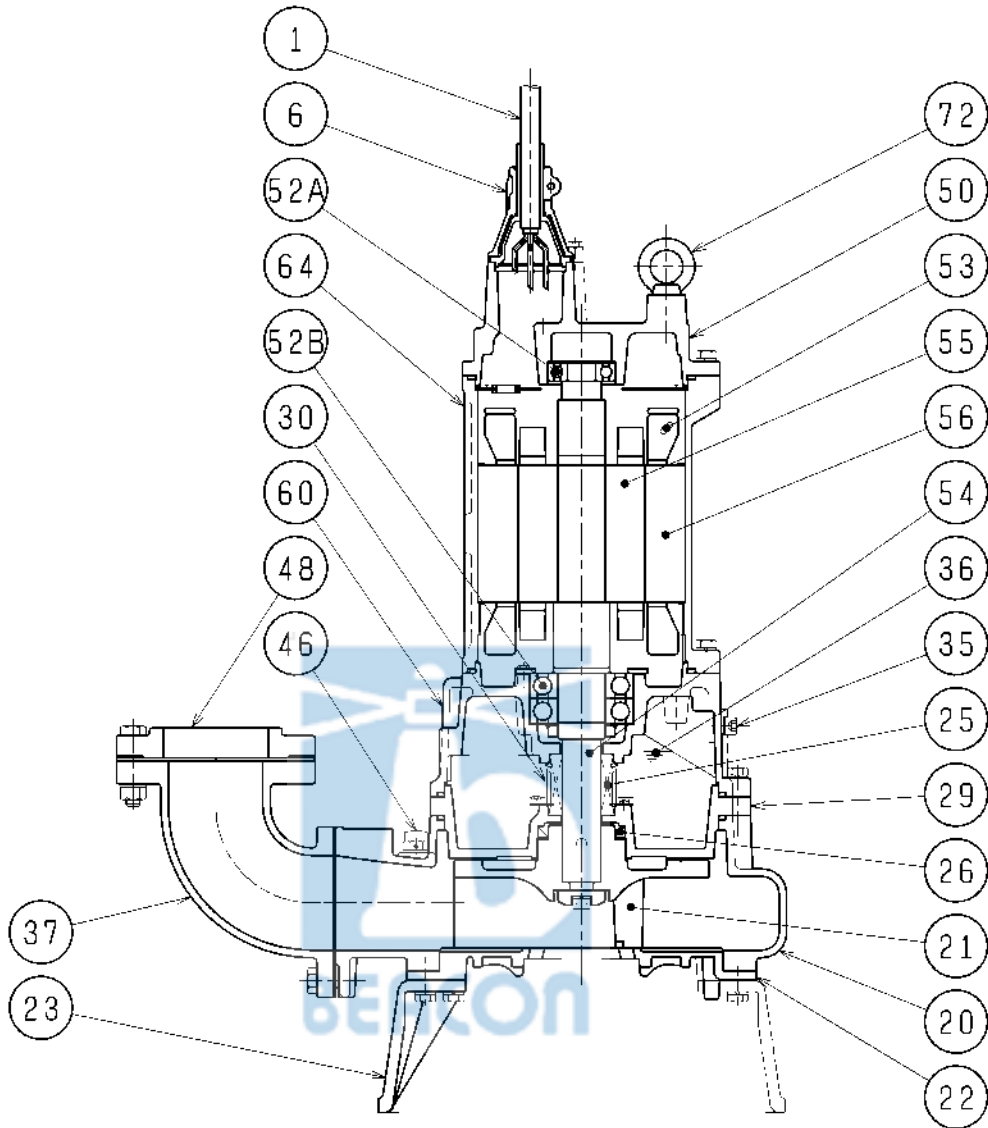

REQ. SPECIFICATION

No.	DESCRIPTION	QTY	MATERIAL / NOTE	No.	DESCRIPTION	QTY	MATERIAL / NOTE
1	Cable	3	Chloroprene Sheath	48	Screwed Flange	1	Gray Iron Casting
6	Stuffing Box	2	Gray Iron Casting	50	Motor Bracket	1	Gray Iron Casting
20	Pump Casing	1	Gray Iron Casting	52A	Upper Bearing	1	6306ZC3
21	Impeller	1	Gray Iron Casting (WC Edge)	52B	Lower Bearing	1	6310ZZD2C3
22	Suction Cover	1	Ductile Iron Casting	53	Motor Protector	3	
23	Stand	3	Gray Iron Casting	54	Shaft	1	Stainless Steel 420J2
25	Mechanical Seal	1	H-40	55	Rotor	1	
26	Oil Seal	1	TC709212	56	Stator	1	
29	Oil Casing	1	Gray Iron Casting	60	Bearing Housing	1	Gray Iron Casting
30	Oil Lifter	1	Plastic	64	Motor Frame	1	Gray Iron Casting
35	Oil Plug	2	Stainless Steel 304	72	Eye Bolt	2	Structure Steel
36	Lubricant		Turbine Oil (ISO VG32)				
37	Discharge Bend	1	Gray Iron Casting				
46	Air Release Valve	1	Nylon				

NO. A-18749-1

# PUMP PERFORMANCE CURVES

TYPE Sewage Submersible Cutter Pump	MODEL 100C415 -53 TOS100C415 -53	FREQUENCY 50 Hz
--	-------------------------------------	-----------------

CUSTOMER'S NAME \_\_\_\_\_

EQUIPMENT TITLE \_\_\_\_\_ NO. \_\_\_\_\_

	STANDARD SPECIFICATIONS	REQUIRED SPECIFICATIONS
DISCHARGE BORE	100 mm	mm
TOTAL HEAD	22 m	m
CAPACITY	1.2 m <sup>3</sup> /min	m <sup>3</sup> /min
MOTOR OUTPUT	15 kW	kW
PHASE x VOLTAGE	3 φ x V	φ x V
CURRENT	A	A
POLES / REVOLUTION	4 P / s. s. 1500 min <sup>-1</sup>	P / min <sup>-1</sup>
STARTING METHOD	STAR-DELTA	
INSULATION CLASS	F	

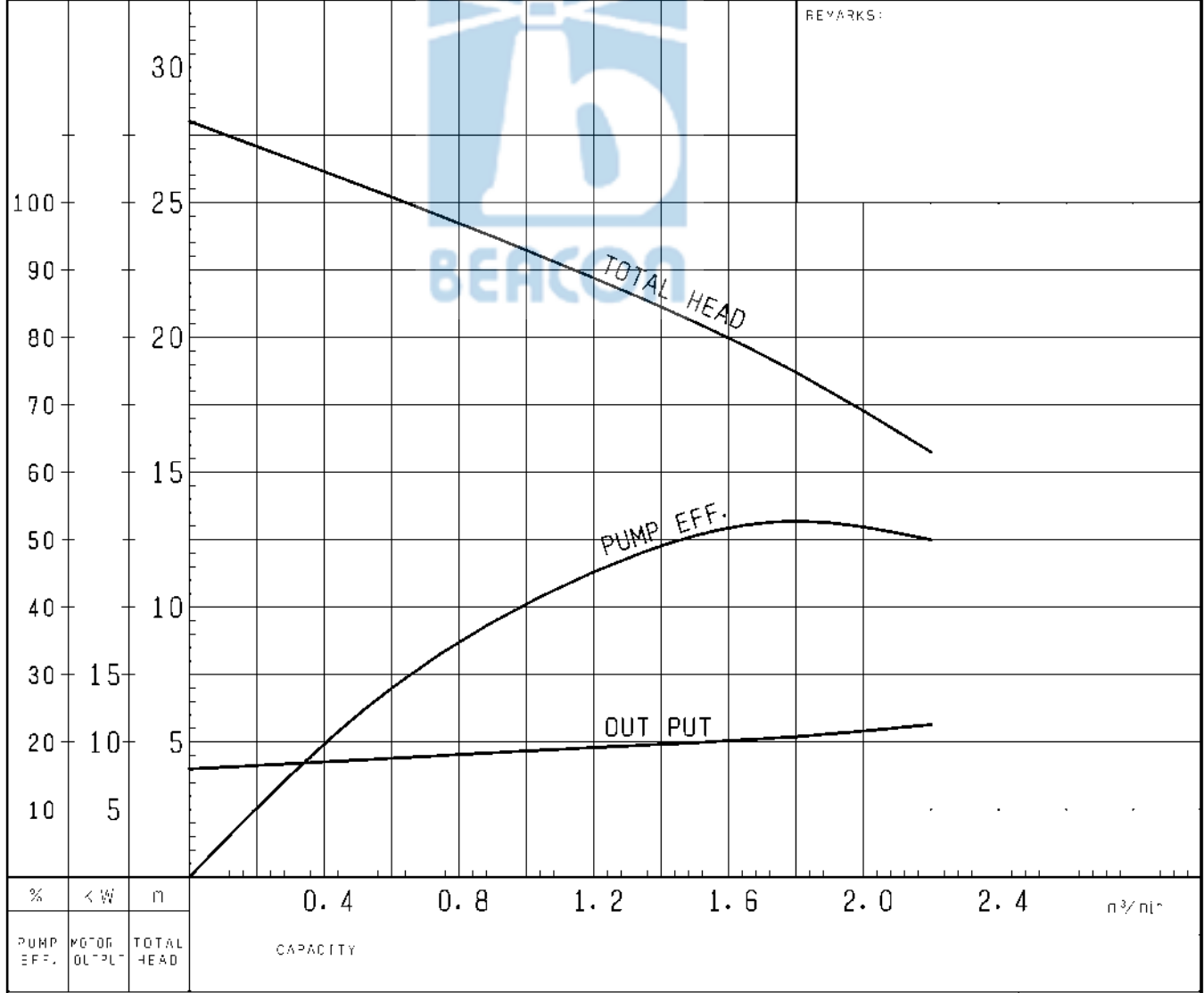

TSURUMI MFG. CO., LTD.

DIMENSION DRAWING		No.	No. A-18783-1
TYPE	Sewage Submersible Cutter Pump	MODEL	100C415 -53/63

Approximate Weight(\*)  
320kg  
\*excluding cable

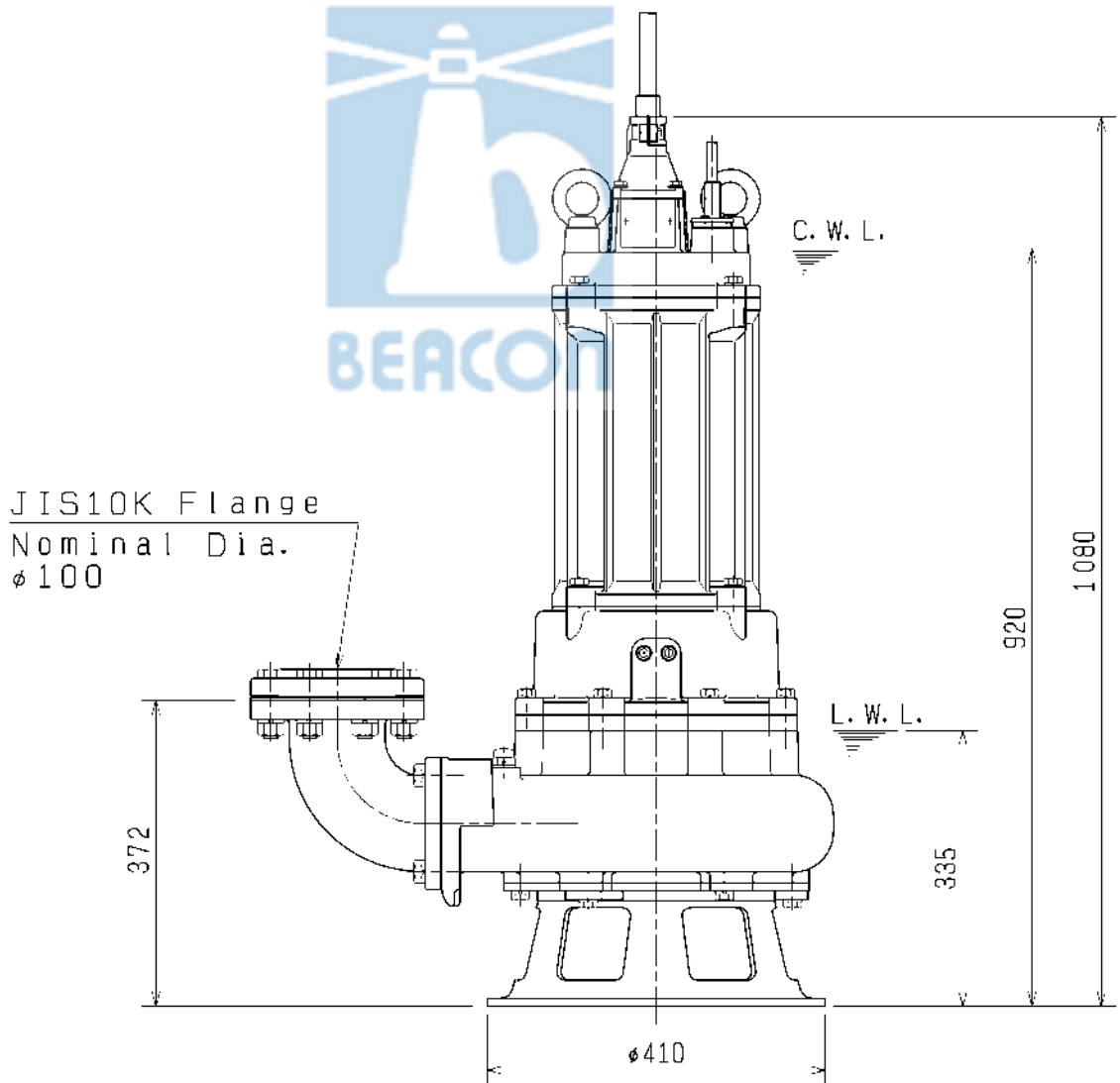
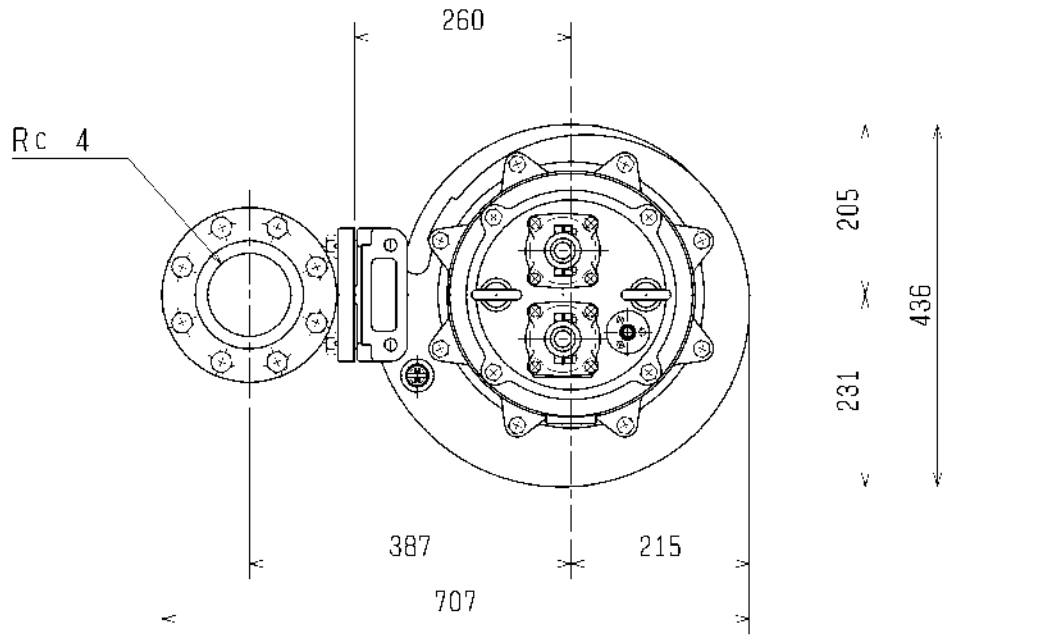

C.W.L. :Continuous running Water Level  
L.W.L. :Lowest running Water Level

<b>SECTIONAL DRAWING</b>		No.	No. A-18800-1
TYPE	Sewage Submersible Cutter Pump	MODEL	100C415 -53/63

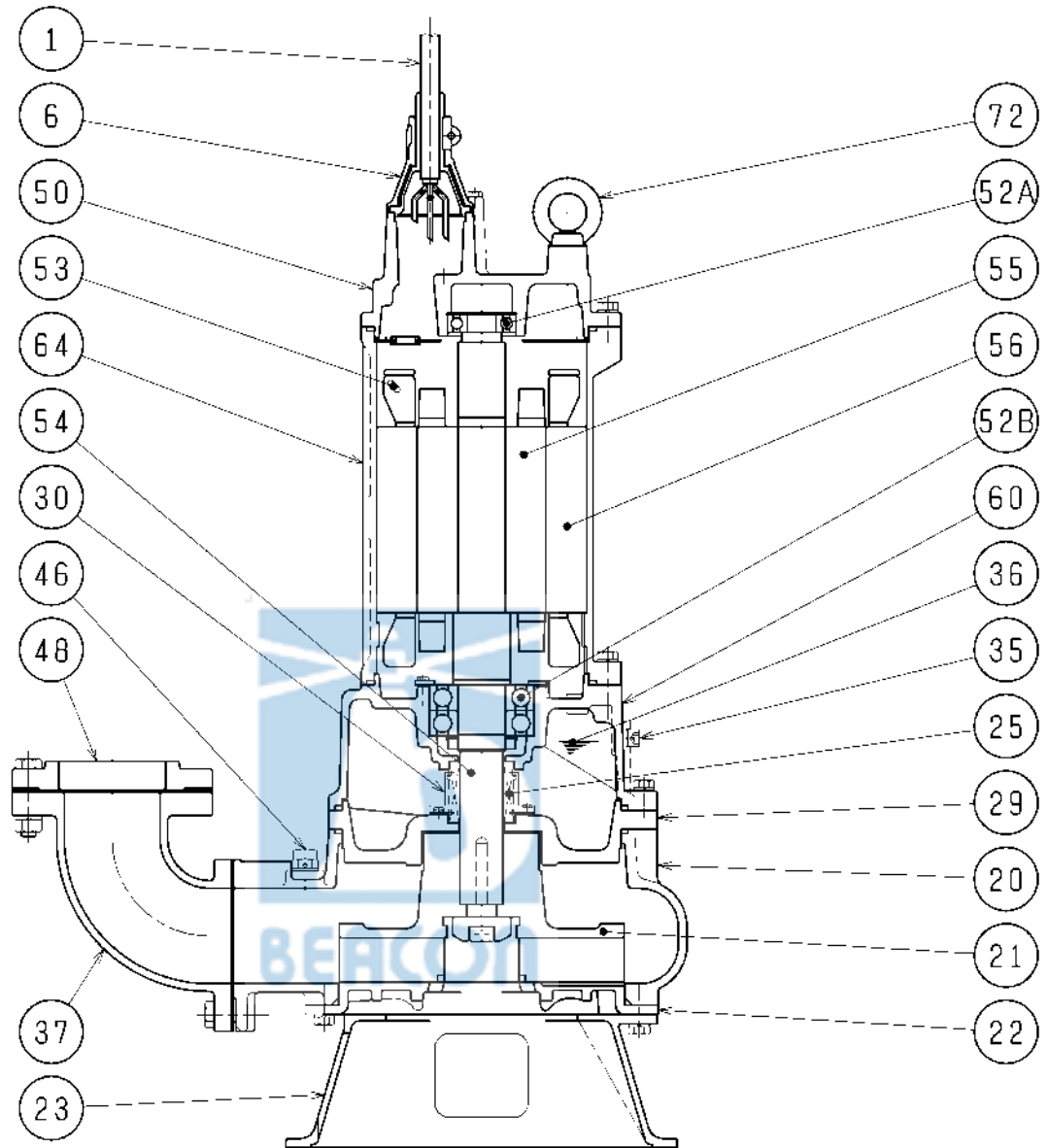

REQ. SPECIFICATION

No.	DESCRIPTION	QTY	MATERIAL / NOTE	No.	DESCRIPTION	QTY	MATERIAL / NOTE
1	Cable	3	Chloroprene Sheath	48	Screwed Flange	1	Gray Iron Casting
6	Stuffing Box	2	Gray Iron Casting	50	Motor Bracket	1	Gray Iron Casting
20	Pump Casing	1	Gray Iron Casting	52A	Upper Bearing	1	6306ZZC3
21	Impeller	1	Gray Iron Casting (WC Edge)	52B	Lower Bearing	1	6310ZZD2C3
22	Suction Cover	1	Ductile Iron Casting	53	Motor Protector	3	
23	Strainer Stand	1	Malleable Iron Casting	54	Shaft	1	Stainless Steel 420J2
25	Mechanical Seal	1	H-45	55	Rotor	1	
29	Oil Casing	1	Gray Iron Casting	56	Stator	1	
30	Oil Lifter	1	Plastic	60	Bearing Housing	1	Gray Iron Casting
35	Oil Plug	2	Stainless Steel 304	64	Motor Frame	1	Gray Iron Casting
36	Lubricant		Turbine Oil (ISO VG32)	72	Eye Bolt	2	Structure Steel
37	Discharge Bend	1	Gray Iron Casting				
46	Air Release Valve	1	Nylon				